



Each tent is a **beautiful
landscape**

Sichuan Tourle Outdoor Products Co.,Ltd

Tel: +86 13088053784

Email: hannah@tourletent.com

Web: www.tourletent.com



PRODUCT
CATALOGUE
2020 THE 1ST PHASE
LUXURY TENT

CONTENTS



2015 Buddha Hall Campground

Living in luxury camping tents, staring up the starry sky, opening the door and going into the landscape, combining the fun of camping with the comfort of the hotel; enjoy the beautiful nature in a comfortable way.

2018 Yiting Campground

Every product is the proud artwork we made, to give you an original life experience.



2019 Bamboo Campground

Hotel tent with classical Boteen model T-9 and M8, the perfect match sets off the idyllic theme of the campsite, which contains low-key luxury.

We are committed to providing each customer with an ideal resident tent and enjoying the beauty of nature.

● Company profile	01-02
● Boteen advantages	03-04
● Fabric introduction	05-06
● Product introduction	07-56
● Supporting facilities	57-65
● Campground cases	66-80
● Special services	81-86
● Certificates	87-88

Tourle Company

Create a Gorgeous, Natural and Comfortable outdoor life.



Tourle tents have always been based on self-built production lines and production technologies. Our chief overseas designers have created original designs, with the most suitable tent fabric and the best quality accessories. Tourle creates a gorgeous, natural and comfortable life experience for outdoor travelers.

WHY DO YOU CHOOSE US

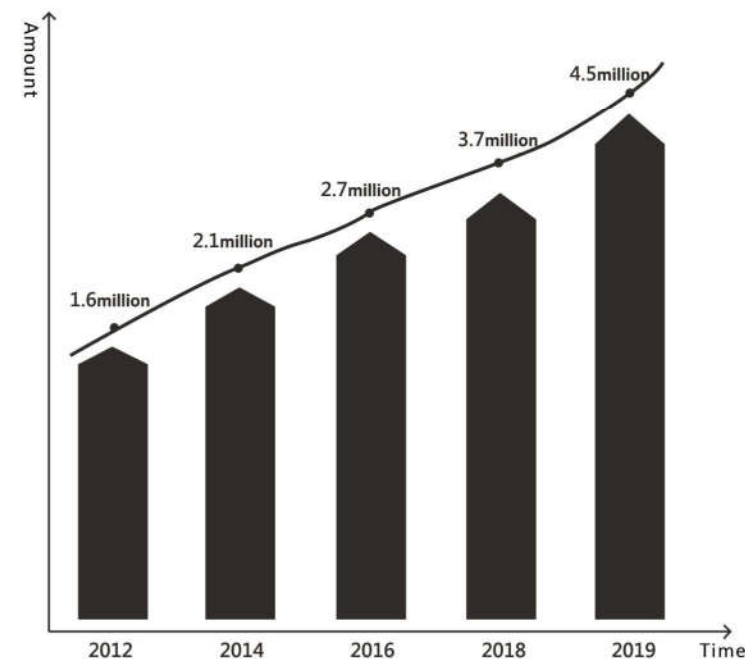

KEEP GROWING

【Annual sales amount increase several times】

After 8 years of operation and development. Tourle outdoor has actively explored the development path of “tent hotel” and made another breakthrough, now tourle have been one of the iconic brands in the domestic hotel tent area.

COOPERATION PARTNER



Boteen has a cooperative relationship with resorts, campgrounds and tourism development departments, and is a leader in future tourism business.



Fabric/material introduction

Cloth Material

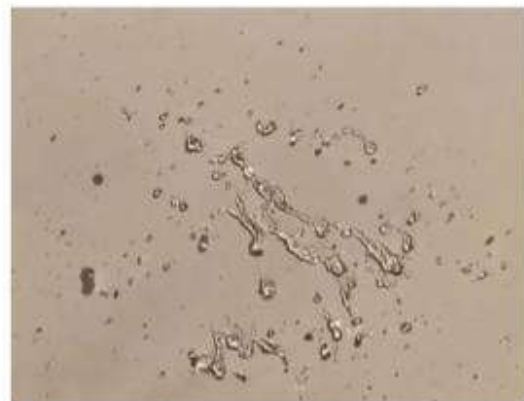

Fabric/Waterproof

Oxford material- Beige/PU coating, 3 layers+ waterproof 5000-7000+



Material /fire resistance

USA 84 standard - Both waterproof and fire resistance



Material/UPF protect

UV coating 80-90%, if set up tents without UV protection during hot season, the inner temperature would be very high.



Main pole/ /Galvanized steel pole

Main pole: Galvanized steel pole: Dia 76mm/ Wall thickness 1.5mm;

Color: Inspection after electroplating processing.



Main pole / Solid wood

Dia 80mm, Synthetic anti-corrosion wood, surface polishing, anti-corrosion treatment, anti-aging wood wax oil.



Regular poles/ Steel poles

Regular poles: 83-89mm, steel poles, wall thickness 2mm, strong;
Process: Black, outdoor special painting treatment/argon arc welding (durable under the sun and rain).



Material/ Mildew resistance

Mildew resistance tents have the ability to inhibit mold germination and mycelial growth.



SBS Zipper

All the zipper comes with Brand zipper SBS.



Fabric/Test

Boteen tent fabrics comply with international quality certification. Test items: Waterproof, fireproof, UV protection and other qualified Boteen tents will never use untested materials.

Cloth inspection report



THE FEATURES OF
THE TENT HOTEL

Zero pollution construction: recyclable materials, natural and environmentally friendly

Assembled house: fast construction speed, low cost

High safety performance: wind resistance can reach level 10, tarpaulin B1 fireproof, fire resistance

Beautiful appearance: The tent hotel is designed to be flexible and adapt to local conditions to fully enjoy the beauty of nature

Comfortable and livable: a variety of modern facilities, adapted to the perfect combination of nature and technology

Good investment prospects: compound holiday model of scenic spots + tent camping, emerging tourism trends

PRODUCT INTRODUCTION



[The brochure only shows some conventional products. Our company accepts customized high-end tent hotels.

The size, material and pattern can all be customized according to customer needs]

M-9 When the tent meets the wooden house, it creates an extreme, unique upper and lower double-layer design, which seems to add a small attic; at night Ft talks with the stars and blends with nature. Let people get back to nature, forget their troubles and fatigue, and comprehend life's spiritual rest in peace and nature.



Model NO.	Overall size(m)	Indoor size(nn)	Overall area (m²)	indoor {rrf)
M-9	5.0*9.0*3.6	4.7*6* 3.3	45.0	28.2

Rain fly material standard rain; 420g cotton canvas

Inner material: 360g cotton canvas, waterproof 5000mm

Wind proof: 8-9 level, 50-88km/h

Structural material: main pole, BO mm synthetic anticorrosive wood, surface polishing, anti-corrosion treatment with wood wax oil; connecting pole. 88mm steel pipe wall thickness 2.0mm;Black, outdoor special painting treatmer^t/argon arc welding (durable under the sun and rain).

Fabric material: 420g cotton canvas, PU Coating, waterproof 5000mm UV protect 50+. fine resistance

(CPAI-84) US standard, mildew proof Anti-mosquito

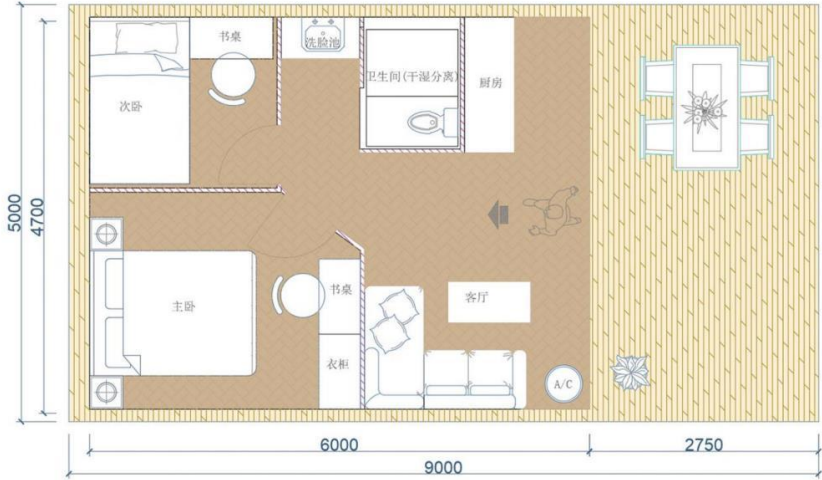

M-8 Duplex Tent Indoor Drawing

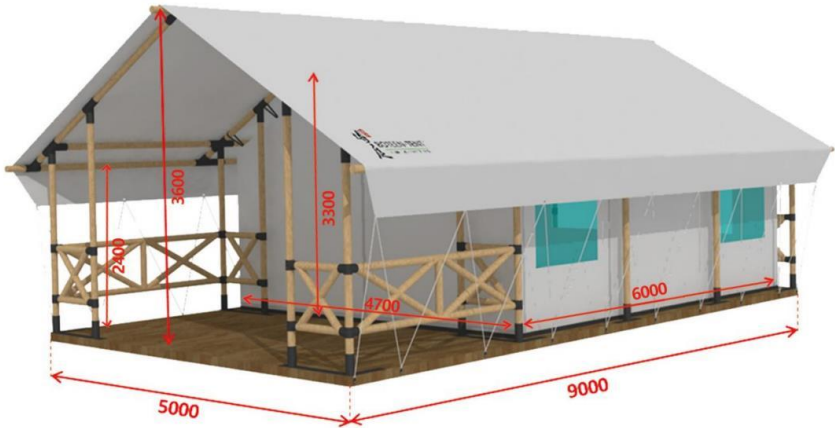

M-8 Duplex Tent Dimensions

M-9 LOFT When the tent meets the wooden house, it creates an extreme, unique upper and lower double-layer design, which seems to add a small attic; at nighty Ft talks with the stars and blends with nature. Let people get back to nature, forget their troubles and fatigue, and comprehend life's spiritual rest in peace and nature.



Model NO.	Overall size(m)	Indoor size(nn)	Overall area (m²)	indoor {rrf }
first floor	5.0*9.0*4.5	4.7*6.0*4.3	45	28.2
second floor	-----	4.7*6.0*1.9	----	28.2

Rain fly material standard rain; cotton canvas
Inner material: 360g cotton canvas, waterproof 5000mm
Wind proof: 8-9 level, 50-88km/h
Structural material: main pole, BO mm synthetic anticorrosive wood, surface polishing, anti-corrosion treatment with wood wax oil; connecting pole. 88mm steel pipe wall thickness 2.0mm;Black, outdoor special painting treatmer^t/argon arc welding (durable under the sun and rain).
Fabric material: 420g cotton canvas, PU Coating, waterproof 5000mm UV protect 50+. fine resistance
(CPAI-84) US standard, mildew proof Anti-mosquito



M-8 Duplex Tent Indoor Drawing



M-8 Duplex Tent Dimensions

M - 8 mini loft Due to the unique wooden structure, the tents are cleverly integrated in the mountains and grasslands.

The classical decoration style and modern technology products are perfectly combined, simple and not monotonous. They are interlaced and integrated to form the most classic indoor art.



Model NO-	Over«i II size(m)	Indoor size(m)	Overall area (m *)	Indoor (rrf)
first floor	-----	3.5*5.1*2.3	-----	19.4
second floor	4.0*5*3.6	3.5*4.7*3.3	20	16.5

- Color: Army green & khaki
- Outer cover material: 1680D PU coatin oxford fabric
- Inner cover material: 900D PU coatin oxford fabric
- Water proof: Water resistant pressure (WP7000) UV proof: UV proof (UV50+)
- Structure: Φ80mm synthesize anticorrosion wood Wind Load: 88km/h
- Connecting pipe: Φ86mm stainless steel pipe
- Door: 1 door with zipper mesh Window: 9 windows with zipper mesh
- Accessories:Stainless steel bolt and nail, plastic buckle, wind ropes etc,



M-8 mini loft Tent Indoor Drawing



M-8 mini loft Tent Dimensions

M - 8 Due to the unique wooden structure, the tents are cleverly integrated in the mountains and grasslands. The classical decoration style and modern technology products are perfectly combined, simple and not monotonous. They are interlaced and integrated to form the most classic indoor art.



Model NO-	Over«i II size(m)	Indoor size(m)	Overall area (m*)	Indoor (rrf)
M-8	5*9.0*4M	4.7*6.25*3.5M	45	29.3

Rain fly material: standard rain fly/1680D strong oxford material/ 7SOg Stretch film

Inner material; 900D st rang oxford, waterproof SOOOmm

Wind proof: S0-B8km/h

Structural matenah main pale. 80m<Ti syriihetic anti-corrosive wood, iurface polishing, anti-corrosion treatment, with wood wax oil; connecting pole. 88mm pipe wall thickness. 2.0mm. Black, outdoor special paming ireaiment/argan arc welding (durable uhd?r the sun and rain).

Fabric material: 16S0D strong oxford material, PU Coating, waterproof 7000mm, UV protect 50*, fire nesistance (CPAI-84) US stBrtbard, mildew proof. And-mosquito, Army green

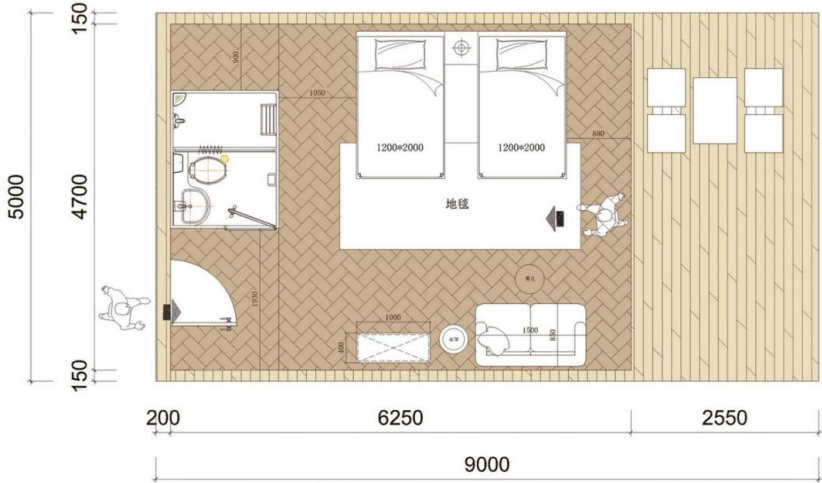

M-8 Tent Indoor Drawing

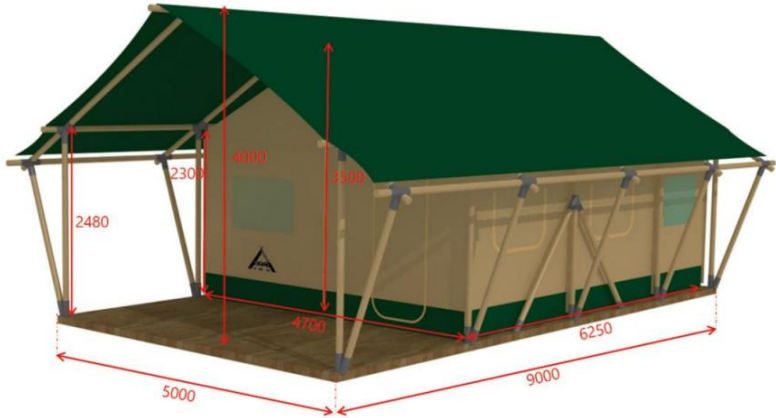

M-8 Tent Dimensions

M8-T Modern interior construction, suitable for bathroom, bedding and other facilities. So that you can enjoy the convenience and comfort of a S-star hotel lifestyle in wild nature.



Model NO.	Overall sizefm)	indoor size(m)	Overall srea (M)	indoor (m')
M8-T	3*4.5*4	5*9*4	13.5	40.8

Rain fly material: standard rain fly/ 750g Stretch him

Inner material; 420g cotton canvas, waterproof 5000mm

Wind proof: 8-10level. 62-102km/h

Structural material: main. pole; 80mm synthetic anti-corrosive wood, surface polishⁱ anti-corrosion treatment with wood wax。 巾 connecting pole, 88rum steel pipe wall thickness. 2.0mm, Black, outdoor gpeol painting trpatmem/argtin art welding (durable under LhG 5un and rain).

Fabric material: 750gStretch film. self-wash function, waterpfcx>f 10000mm, UV protect 50+, fire nesistaoce (CPA!-84 } US stBrtdflrd, mildew proof, An th mosquito. Army green



M8-T Tent Indoor Drawing

M8-T Tent Dimensions

M Based on simple and elegant, from the exterior decoration materials to the interior decoration, it uses the simplest wood and cloth. The natural flavor will bring you back to the era of the grassland nation.



M Tent Drawing

Model NO.	Overall size(m)	Indoor Size(m)	Overall m ² (m')	Indoor (rtf)
M	5*6*3.5	<6*4*3.5	30	18.4

Rain fly material: standard rain fly/ *Gauze*/ 1680D Strong Oxford
Inner material: 900D Strong Oxford, waterproof 5000mm
Wind proof: B-iOkv^I, 50-88km/h

Structural material: main. pole, 80mm synthetic anti-corrosive wood, surface polishⁱ anti-corrosion treatment with wood wax。巾 connecting pole, 88mm steel pipe wall thickness. 2.0mm, Black, outdoor gpeol painting trpatmem/argtin art welding (durable under LhG 5un and rain).

Fabric material: 1680D Strong Oxford. PU Coatiivg, waterproof 7000mm, iJV protect 50+, fire resistance (CPAb84) US standard, mildew proof. Anti-mosquito. Beige



M Tent Dimensions

I Small A The comfortable and natural integrated space design, Top-ieval rain fly and fabric matching the best leisure place for dinner and dating, will leave you unforgettable memories.



Model NO.	Overall size(m)	Indoor size(m)	Overall area (m ²)	Indoor (m ²)
Small A	4.5*3.5	3.86*3.86*3.2	20	14.2

Ram fly material: 1680DStrong Oxford

Inner material: 900D strong Oxford, waterproof 5000mm

Wind proof: 8-10 level 50-88lcm/h

Structural material: mam poie, 80mm ^yrttheilc anti-corrosive wood, surface polishing: anti-corrosion treatment with wood wax oil; conr^ecting pole, 88mrn steel pipe wall thickn.es 2.0mm, Black, outdoor spinal painting treatment/argon arc welding (durable under sun and rain),

Fabric material: 168OD Strong Oxford. PI) Coating, waterproof 730mm UV protect 50+. fire resistance (CRAI-84) US standard, mildew proof, Anti-mosquito. Beige

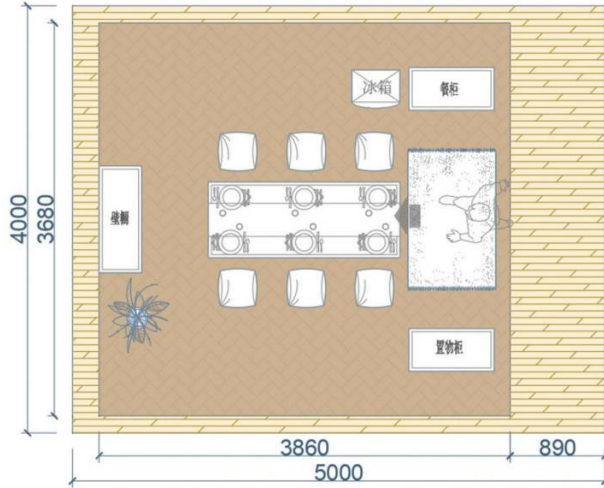

Small A Tent Drawing



Small A Tent Dimensions

K--200 The comfortable and natural integrated space design, Top-ieval rain fly and fabric matching the best leisure place for dinner and dating, will leave you unforgettable memories.

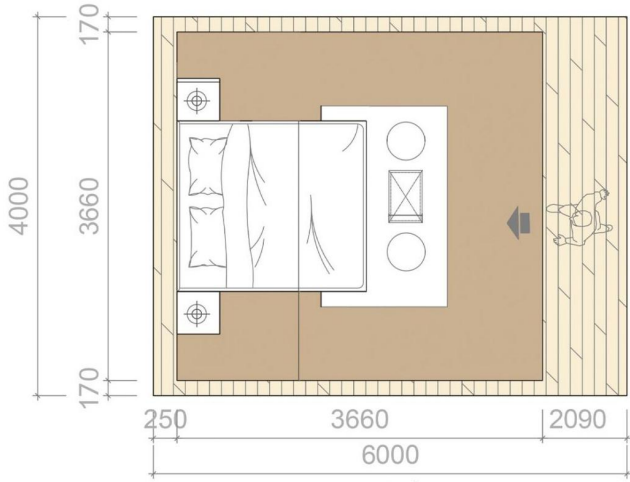

K -200 Tent Drawing

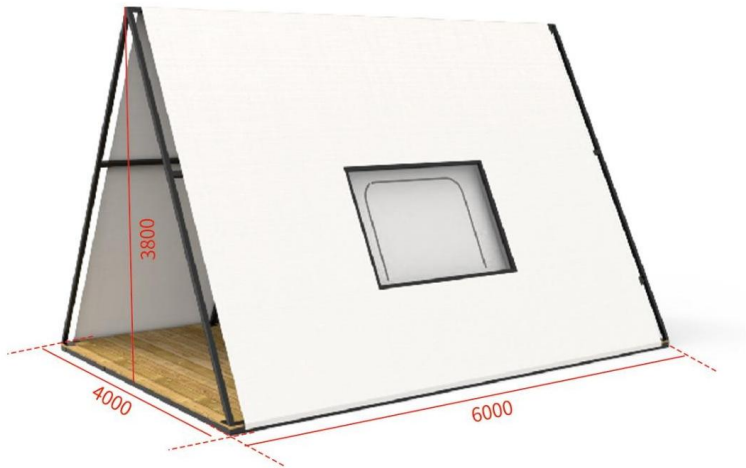

K -200 Tent Dimensions

Model NO.	Overall size(m)	Indoor size(m)	Overall area (m ¹)	Indoor (m ¹)
K-200	4*6*3.8	3.5*3.7*3.5	24	13

Outer cover material:1680D PU coatin oxford fabric Or gauze curtain

Inner cover material:900D PU coatin oxford fabric

Water proof:Water resistant pressure (WP7000)

UV proof:UV proof (UV50+)

Structure:Φ80mm antiseptic wood Wind Load:88km/h

Connecting pipe:Φ83mm stainless steel pipe

Door:1 door with zipper mesh Window: 4 windows with zipper mesh

Accessories:Stainless steel bolt and nail, plastic buckle, wind ropes etc,

M-10 Based on simple and elegant, from the exterior decoration materials to the interior decoration

sil use simplest wood and doth. Perfect for outdoor party weddings.



Model NO.	Overall sizefm)	indoor size(m)	Overall srea (m')	indoor (m')
M-10	10*10*7.48	12.2*12.2*7.48	117	78.5

- Outer cover material:420gcanvas
- Inner cover material: 210gcotton
- Water proof:Water resistant pressure (WP7000)
- UV proof:UV proof (UV50+)
- Structure:Φ80mm antiseptic wood
- Wind Load:88km/h
- Connecting pipe:Φ83mm stainless steel pipe
- Accessories:Stainless steel bolt and nail, plastic buckle, wind ropes etc,
- Color: Khaki

印第安餐厅帐尺寸图

单位: mm

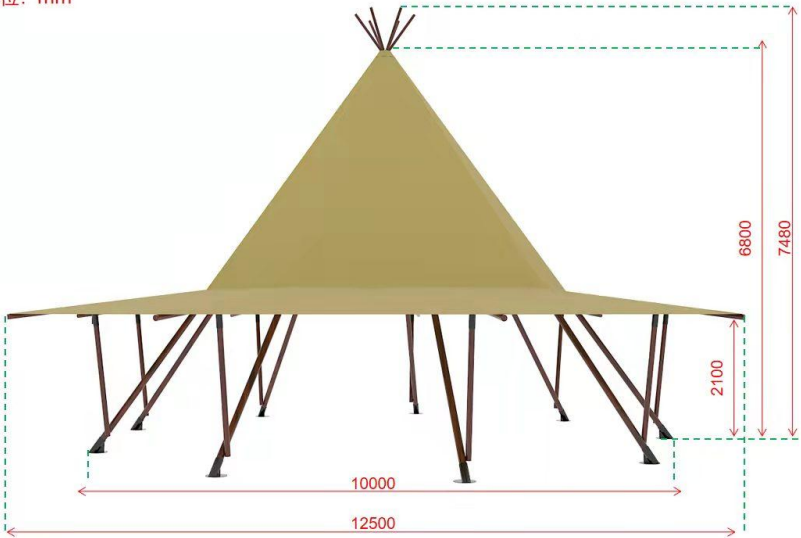

Tent deployment size

印第安餐厅帐尺寸图

单位: mm

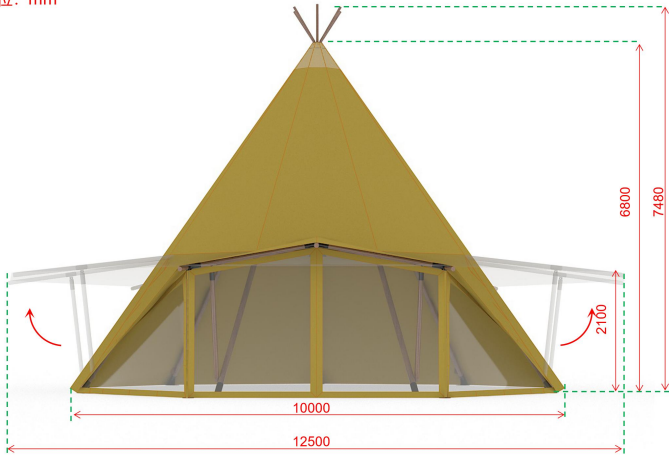

Tent Folded Size

M-11 Luxurious and light luxury style, from exterior materials to interior

They all look high end. Ideal for high end resort hotels.



Model NO.	Overall sizefm)	indoor size(m)	Overall srea (m ^l)	indoor (m ^l)
M-11	6.6*5.9*3.89	7.62*6.9*4.67	52.6	39

- Outer cover material:420g cotton canvas fabric
- Inner cover material:360g cotton canvas fabric
- Water proof:Water resistant pressure (WP7000)
- UV proof:UV proof (UV50+)
- Structure:Φ80mm synthesize anticorrosion wood
- Wind Load:88km/h
- Connecting pipe:Φ86mm stainless steel pipe
- Door:1 door with zipper mesh
- 6Window:9 windows with zipper mesh
- Accessories:Stainless steel bolt and nail, plastic buckle, wind ropes etc,
- Color:khaki



M11 Tent Indoor Drawing



M11 outdoor renderings

M-13 Luxurious and light luxury style, from exterior materials to interior

They all look high end. Ideal for high end resort hotels.



Model NO.	Overall sizefm)	indoor size(m)	Overall srea (m ^l)	indoor (m ^l)
M-13	5*5*3.6			25

- Outer cover material: tensile membrane
- Inner cover material: Canvas/Oxford
- Water proof: Water resistant pressure (WP7000)
- UV proof: UV proof (UV50+)
- Structure: Q235 steel pipe
- Wind Load: 88km/h
- Connecting pipe: Q235 steel pipe
- Door: 2 door with zipper mesh
- 6Window: 6 windows with zipper mesh
- Accessories: Stainless steel bolt and nail, plastic buckle, wind ropes etc,
- Color: khaki

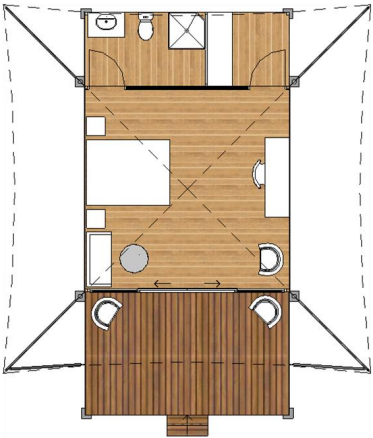

M13 Tent Indoor Drawing



M13 outdoor renderings

M-14 Luxurious and light luxury style, from exterior materials to interior

They all look high end. Ideal for high end resort hotels.



Model NO.	Overall sizefm)	indoor size(m)	Overall srea (m ^l)	indoor (m ^l)
M-14	5*9*4	4.5*6.4*2.8	45	28.8

- Outer cover material: 420g Oxford cloth
- Inner cover material: 360g Oxford cloth
- Water proof: Water resistant pressure (WP7000)
- UV proof: UV proof (UV50+)
- Structure: Φ80mm synthesize anticorrosion wood
- Wind Load: 88km/h
- Connecting pipe: Φ86mm stainless steel pipe
- Door: 1 door with zipper mesh
- Window: 9 windows with zipper mesh
- Accessories: Stainless steel bolt and nail, plastic buckle, wind ropes etc,

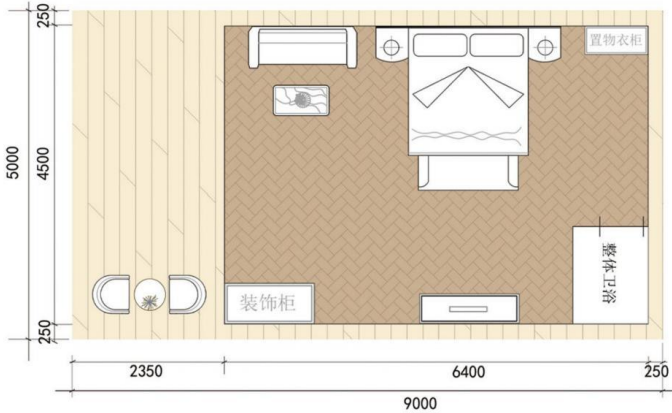

M14 Tent Indoor Drawing



M14 outdoor renderings

I T - 9 Gorgeous and natural, humanized and comfortable facilities and space design, finally upgraded to Model CABANA-T-9

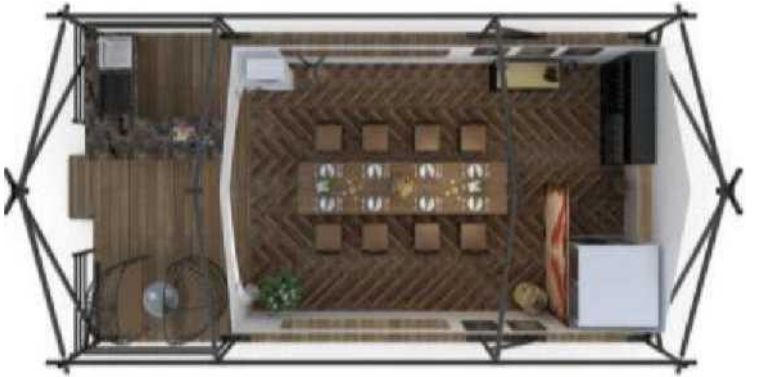

T-9 Tent Drawing

Model NO.	Overall size(m)	Indoor size(m)	Overall area (nV)	Indoor (m")
T-9	5*736	4.5*4.3'3.1	35	19.35
Lengthen T-9	5*9*36	4.5*6.0*31	45	25.80

Rain fly material: standard rain fly/ 1680D Strong Oxford/ 750g Stretch film

Inner material: MOD strong Oxford, waterproof 5000mm

wind proof: 8-10level, 50-88km/h

Structural material: main pole, 76mm galvanized steel pole, 15mm wall thickness.

Connecting pole, 83mm steel pole, 2 0mm wall tt^ckness. outdoor speoal pointing treatment/argon arc welding (durable under the sun and rain)

Fabric material: 16a0D Strong Oxford. PU Coating. waierproof 7000mm. UV protect 50+, fire resistance (CPAI-84) US standard, mildew proof, Anti-mosquito, Seige



T-9tent Dimensions

conference hall, etc. Large space is its advantage and can enjoy the same treatment *as* boutique hotels.



Model NO.	Overall	Indoor size(m)	Overall area (m²)	Indoor (m²)
T-9 Shape Bar	5*12 * 4	4.6*11.5*15	60	52.9
Lengthened T-9 Shape bar	6*18*4.37	5.6*175*18	108	98
T-Shape Bar	6*12+5*5*4.2	5.7*117+5*4.7*3.8	97	90.19

Inner matericik 9000 Strong Oxford, waterproof 5000mm

Wind proof: S-10 level, 62-102km/h

Structural material: main pole. 76mm gMuam把d 馱吨l pole, 1,5mm wall thickness,
Connecting pole. 83nm steel pole 2.0mm wall thtckness, Black, outdoor special
painting treatment/argon arc welding (durable under the sun and rain).

Fabric material: 7S0g Stretch film, self-wash function, waterproof 10000mm. UV protect S0+, fire resistance (CPAI-04) US s^nd^id, mildew proof. Anh-mosquillo. Beige

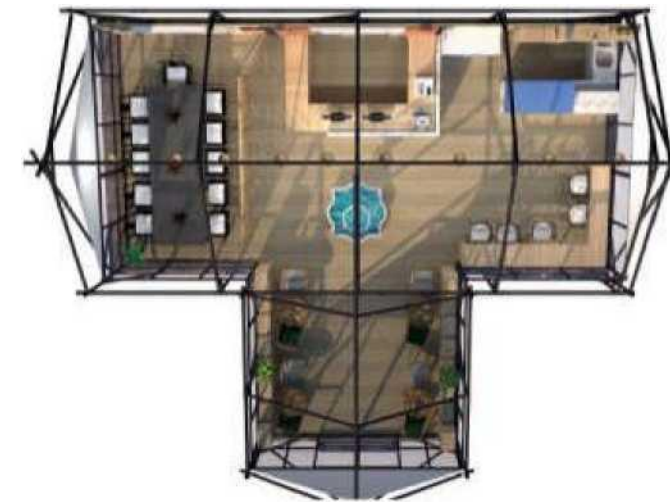

T-Shape Bar Drawing



Lengthened bar (6*18M } Dimensions

I NC - 900 Integrating with nature, away from the fast pace of the city, the combination of simple natural exterior

design with comfortable and luxurious interior decoration is 3 gre^t choice for relaxation.



Model NO.	Overall size(m)	indoor sizetm	Overall area (m")	Indoor (N)
MC*900	5*7*3.6	4.5*3*31		19.3S

Rain fly material: standard m弟 fly/16800 Strong Oxford/ 750g Stretch film

Inner material: 900DStrong: Oxford, waterproof 5000mm

Wind proof: 8 10 level 5。山歟m/h

Structural material: mam pole, 76mm galvanized steel pole, l.Smm wall thickness.

Connecting pole. 83nm steel pol* 2.0mm wall thickness, outd<x>r special painting
(reatment/argon arc 疵l盛凹(durable under the sun and rai n).

Fabric material: 16S0D Strong Oxford. PU Coating, waterproof 7000mm, UV protect SO*,
fire resistance (CPAI-84) US standard, mildew proof, Anti-mosquito, Beige



NC-900 Tent Drawing



NC-900 Tent Dimensions

C - 500

The designer uses a lot of transparent walls to create a feeling of being integrated with nature, which makes people feel comfortable. Sometimes the meaning of travel is not only in the love of mountains and rivers,, but also in enjoying life.



Model NO.	Overall size(m)	Indoor size(m)	Overall area (m ²)	Indoor (m ²)
C-500	4.6*111*3,5	41 *33		

Rain fly material: standard rain fly/7S0g Stretch film

Inner material: 36DG cotton canvas, waterproof SOOOimm

Wind proof: B-1Q level 62-102km/h

Structural material: mam pole. 7&mm galvanized steel pole, 1.5mm wall thickness,
Connecting pole. 83mm ste«l pole, 2.0mm wall thickness, black, cxjtdoor special painting
treatmem/argon arc welding (durable under the sun and rain).

Fabric material: 750G Stretch Film, self wash fuction. waterproof 10000mm, UV protect

50+,. fire resistance

(CRW-84) US standard, mildew proof, Anti-mesqurto, Beige

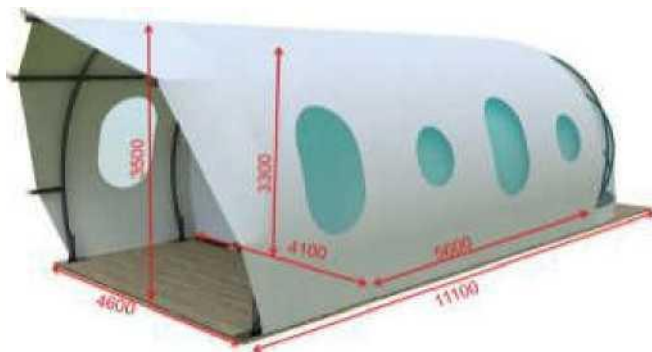

500 Tent Drawing

C^500Tent Dimensions

I C - 300 Simulate the natural form of plants, bend the steel poles into an arc to build a more stable figure, gorgeous and natural.

allowing you to blend into nature.



Model NO.	Overall srze(m)	Indoor s^e(m)	Overall area (m^d)	Indoor (nf)
C-300		4.5*4.5	42.0	20.2
C-300 lengthen	5.1*9.0*41	4.5*6.0*3,8	45.9	27.0

Rain fly matw(3): standard fly/ 168QD Strong Oxford/750g Stretch film

Inner material 9C0D Strong Oxford, waterproof SOOOfnm

Wind proof: level 5O-8fikrn/h

Stfuctucal material: m«iin pole, 76mm galvanized steel pole, 1.5mm wall thickness.

Connecting pole. 83mm steel pole. 2.0mm 网洲 thickness, White / outdoor special parting treatment /argon arc welding (durable under ihesun^Ad rain),

Fabric matenal: 1680D Strong Oxford, PU Coating, waterproof 7000mm, UV protect 50+, (ire resistance

(CPAI-84) US standard, mildew proof, Anti-rnosquito, Beige



C-300 Tent Drawing



C-300 Tent Dimensions

I G - 100 When the khaki tent is tucked into the beautiful scenery, the small space is equipped with various styles of bedding and household items. Everything reflects the unique charm of nature, and is committed to allowing tourists to enjoy the services of high-end hotels while getting close to nature.



Model NO	Overall size(m)	Indoor size(m)	Overall area (m")	Indoor (m')
G 100	4.5-3.3	3.8*3*3	11.8	16.3

Rain fly material: standard ram fly/ 1680D Strong Oxford/ 750g Stretch film

Inner mater>al 900D Strong Oxford, waterproof 5000mm

Wind proof: 8-9 level, 50-83km/h

Structural matenak mam pole, 50*50mm gaMen世ed square steel pole, 2.0mm waJl

thickness, Connecting pole U-Shape Steel trough, 5mm wall lhkknesslStrong}, Orange /

outdoor special painting treatment /argon 恥 welding (durable undei the sun and rain),

Fabric material 1680D Strong Oxford, PU Coating, waterproof 7000mm, UV protect 50*,

fire resistance

(CPAI 84) US standard, mildew proof Antl-mosquita, Light khaki



G-100 Tent Drawing



G 100 Tent Dimensions

I G - 200 The upgraded series of G-100, if you are tired of boutique hotels or fast hotels, you can try Boteen tent with the concept of returning to nature and advocating simplicity, and enjoy the tranquility of nature under the blue sky



G-200 Tent drawing

Model NO.	Overall size(m)	Indoor size(m)	Overall area (m')	Indoor (m')
G 200	4*75-3.6	3.8*3*3	30	16.3

Rain fly material: standard ram fly/ 1680D Strong Oxford/ 750g Stretch film

Inner mater>al 900D Strong Oxford, waterproof 5000mm

Wind proof: 8-9 level, 50-83km/h

Structural matenak mam pole, 50*50mm gaMen世ed square steel pole, 2.0mm waIl

thickness, Connecting pole U-Shape Steel trough, 5mm wall lhkknesslStrong}, Orange /

outdoor special painting treatment /argon 恥 welding (durable undeI the sun and rain),

Fabric material 1680D Strong Oxford, PU Coating, waterproof 7000mm, UV protect 50*,

fire resistance

(CPAI 84) US standard, mildew proof Antl-mosquita, Light khaki

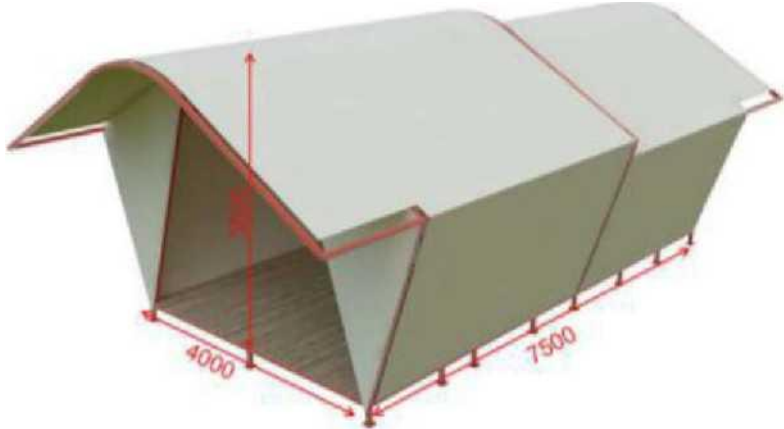

G-200Tent dimensions

I B - 100 The inside of the tent can be arranged into various types of themed tents, with a small space for comfortable luxury campEng.

For example, Egypt, Paris and other decoration styles are comparable to ordinary boutique hotels, creating a comfortable sense of space.



B-100 Tent drawing



B-100 Tent dimensions

Model NC.	Overall size(m)	Indoor size(m)	Overall area (对)	Indoor (m!)
8-100	4 06'61.6*3.1S	37*3.7*3		12.2

Rain fly EM前al: standard rain fly/ 900。 Strong Oxford

Inner material: 900D Strong Oxford, waterproof 5000mm

Wind proof: 7 8 level, 5D-88km/h

Structural material; mam pole, 4Smm galvanized steel pole, 1.5mm wall thickness

(strong and stainless). Connecting pole. 50mm steel pole, 15mrn

wall !hickne\$5 (strong), black / outdoor special painting treatment /argon arc welding

(durable under 由府 sun and rain).

Fabric material: 900D Strong Oxford, PU Coating, waterproof 5000mm, UV protect 50+.

fire resistance

(CRW-84) US standard, mildew proof, Anti-mesqurto, Beige

I B - 300 As Boteen' s most popular catering and conference tent, it uses the smallest space to highlight the most luxurious products and strives to bring people the most extreme outdoor experience,



Model NO	Overall size(m)	Indoor siie(m)	Overall area (m*)	Indoor (m*)
B-300	3*3*3	2.7*2.7*2.8	9	7.29

Rain fly material: standard rain fly/ 9000 Strong Oxford

Inner matenal 9O0D Strong Oxford, waterproof 5000mm

Wind proof: B-9 level, 50-Wkm/h

Structural material: mam pole, 76mm galvanized steel pole. 1.5mm wall thickness, Connecting pole, 83mm steel pole, 20mm wall th<ckness(strong) black/outdoor special painting treatment /argon arc welding (durable under the sun and ram).

Fabric material 9O0D Strong Oxford, PU Coating, waterproof 5000mm. UV protect 50*.

fire resistance

(CPAI 84) US standard, mildew proof, Anti mosquito, Beige



B-300 Tent drawing



B-300 Tent dimensions

I B - 400 The inspiration comes from the feelings of life, as if you are in the forest. The perfect combination of cloth and board gives you a primitive life experience.



Model NO.	Overall size(m)	Indoor size(m)	Overall area (m*)	Indoor (m ^l)
B-400	3*4.5*3	2.7*27*2.8	13.5	7.29

Rain fly material: standard rain fly/ 900D Strong Oxford

Inner material: 900D Strong Oxford, waterproof 5000mm

Wind proof: 8-9 level, 50-88km/h

Structural material: main pole, 76mm galvanized steel pole, 1.5mm wall thickness, Connecting pole, 83mm steel pole, 2.0mm wall thickness(strong), black / outdoor special painting treatment/argon arc welding (durable under the sun and rain).

Fabric material: 900D Strong Oxford, PU Coating, waterproof 5000mm, UV protect 50+, fire resistance

(CPAI-84) US standard, mildew proof, Anti-mosquito, Beige



B-400 Tent drawing

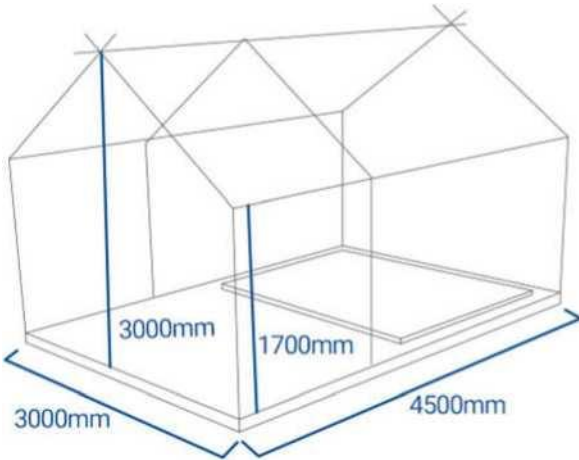

B-400 Tent dimensions

carriage tent conestoga wagon carriage tent is the most popular glamping tent one , It "Fully functional, 2M long, 2× 1M9 wide, lying area can be opened at both ends, storage, "adopt solid natural rubber tire, with wear resistance, high temperature resistance, skid resistance, corrosion resistance and anti-static characteristics. Flexible and mobile, it is the first choice for outdoor tents。

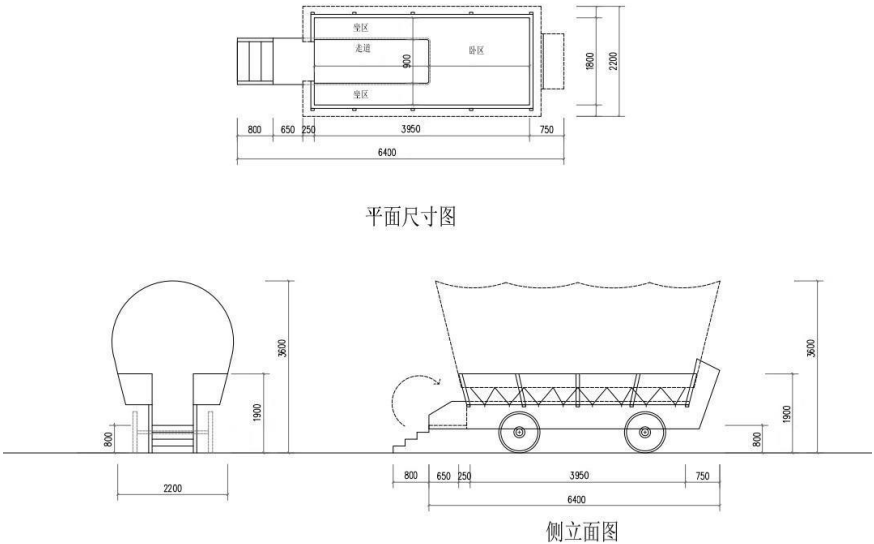

carriage tent Tent Indoor Drawing



carriage tent outdoor renderings

Model NO.	Overall size(m)	indoor size(m)	Overall srea (m ²)	indoor (m ²)
carriage tent	6.4*2.2*2.6	5.6*1.8*1.9	52.6	39

- Color: burlywood color, or customized
- Shock absorption: Use custom 8mm spring, each car has 4 groups of spring composition,good damping effect, high durability.
- braking systems: Tubing using copper tube, copper tube corrosion resistance, Electric car brake, using hydraulic hub brake.
- Wheel tyre: "Adopt solid natural rubber tire, with wear resistance, high temperature resistance, skid resistance, corrosion resistance and anti-static characteristics.
- Sparepart: All U wire, screws, nuts, hub sleeve are galvanized, anticorrosive and rust resistant.

Star Capsule double layer Star Capsule double layer is an innovative mobile building developed by the company from a new design. Created with the starry sky as the main image, it combines the creative elements of sci-fi future and nature. It has a shock-resistant structure, a space aluminum alloy shell, a double-layer broken bridge glass, a multi-layer thermal insulation and waterproof system, and a solid wood interior, which can be used for more than 20 years. You can choose different configurations for star capsules, skylights, bathrooms and more.

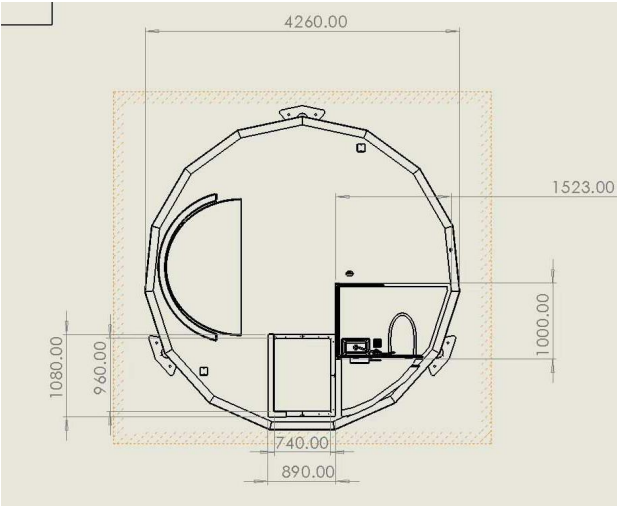

Star Capsule inner drawing

Model NO.	Diameter dimension(m)	area covered (m ¹)
Star Capsule double layer	4.5*4.26m	---

Frame Material:Aluminum wood structure
Cover Material:Aluminum veneer Use Life:20 years
Door:Ladder remote control on and off Wind Load:100km/h
Window:Triangular glass skylight Snow Load:75kg/m²
Features:100% waterproof, flame retardent, anti mildew, anti corrosion,UV protection
Temperature:Can resist temperature from -30℃ to 60℃
Accessories:fixed base, crew and so on

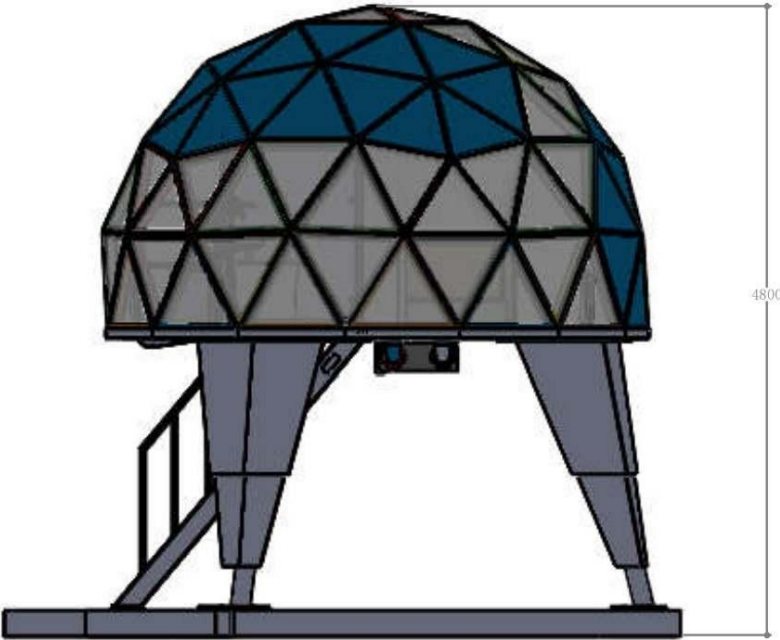

Star Capsule outdoor renderings

Star Capsule single layer Star Capsule single layer is an innovative mobile building developed by the company from a new design. Created with the starry sky as the main image, it combines the creative elements of sci-fi future and nature. It has a shock-resistant structure, a space aluminum alloy shell, a double-layer broken bridge glass, a multi-layer thermal insulation and waterproof system, and a solid wood interior, which can be used for more than 20 years. You can choose different configurations for star capsules, skylights, bathrooms and more.



Model NO.	Diameter dimension(m)	area covered (m ²)
Star Capsule single layer	6m	28

Frame Material:Aluminum wood structure
Cover Material:Aluminum veneer Use Life:20 years
Door:Ladder remote control on and off Wind Load:100km/h
Window:Triangular glass skylight Snow Load:75kg/m²
Features:100% waterproof, flame retardent, anti mildew, anti corrosion,UV protection
Temperature:Can resist temperature from -30℃ to 60℃
Accessories:fixed base, crew and so on

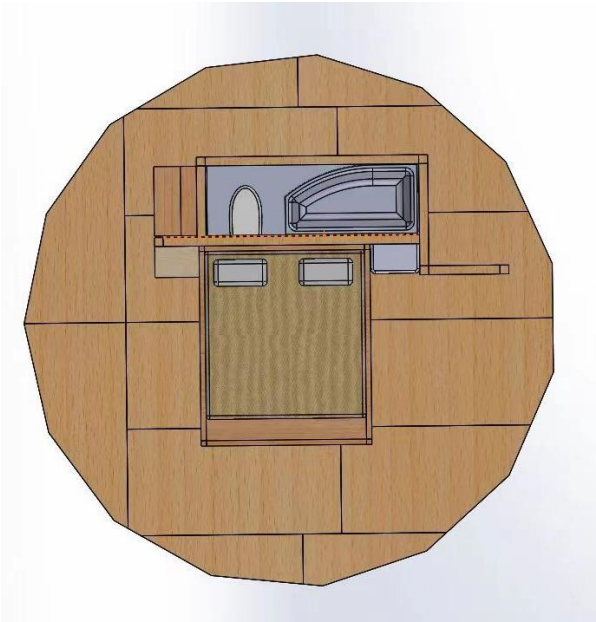

Star Capsule inner drawing



Star Capsule outdoor renderings

I Dome tent Perfectly combining modernization and nature, the overall function of this tent has a sense of elegance that transcends time and fashion.



Model NO.	Diameter dimension(m)	area covered (m²)
dome tent	5/6/8	19.62/28.26/50.24

Fabric material: 850G Stretch film, Transparent thickness 0.5mm
Lining material: High quality stretch cotton, thickness 1mm
Wind proof: 8-9 level, 50-88km/h
Structural material: Galvanized steel pole with white paint, out diameter 26-28mm, wall thickness 1.5mm-2mm, mildew proot Anti-mosquito, Beige



Ball shape tent inner drawing



Ball shape tent dimensions

Glass domee is an innovative mobile building developed by the company from a new design. Created with the starry sky as the main image, it combines the creative elements of sci-fi future and nature. It has a shock-resistant structure, a space aluminum alloy shell, a double-layer broken bridge glass, a multi-layer thermal insulation and waterproof system, and a solid wood interior, which can be used for more than 20 years. You can choose different configurations for star capsules, skylights, bathrooms and more.



Model NO.	Diameter dimension(m)	area covered (m ²)
glass dome	4-8m	---

Frame Material:Aluminum alloy 6063-T5 glass ball triangle frame (aluminum alloy)

Frame profile section width 50mm; thickness 2mm

Frame material: high-strength oxidized aluminum alloy material, no rust, no deformation, anti-corrosion, strong and tasteless; the service life is more than 30 years;

Frame colors available:Double-layer hollow coated tempered glass, coating color: emerald green, sky blue

Note: The glass can be double-layer hollow tempered glass (5+9A+5) or double-layer laminated tempered glass

Glass coating color can be selected: emerald green, sky blue, gray, transparent, etc.

(The service life of glass is more than 20 years)Window:Triangular glass skylight
Snow Load:75kg/m²

Features:100% waterproof, flame retardent, anti mildew, anti corrosion,UV protection

Temperature:Can resist temperature from -30℃ to 60℃

Accessories:fixed base, crew and so on

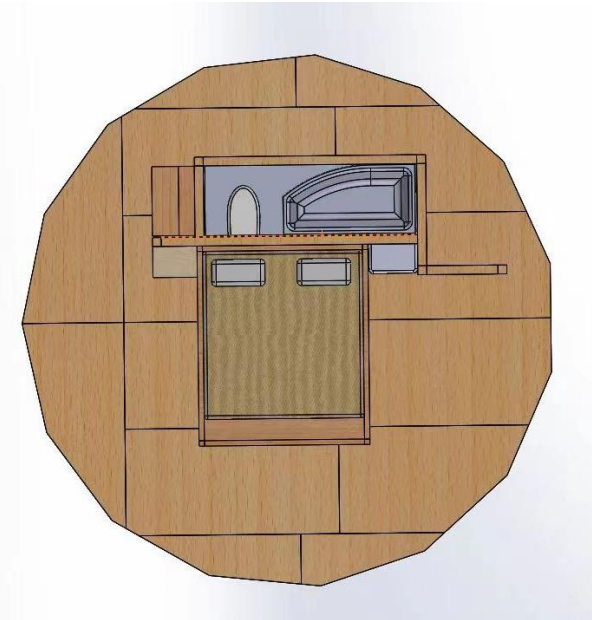

Glass dome inner drawing

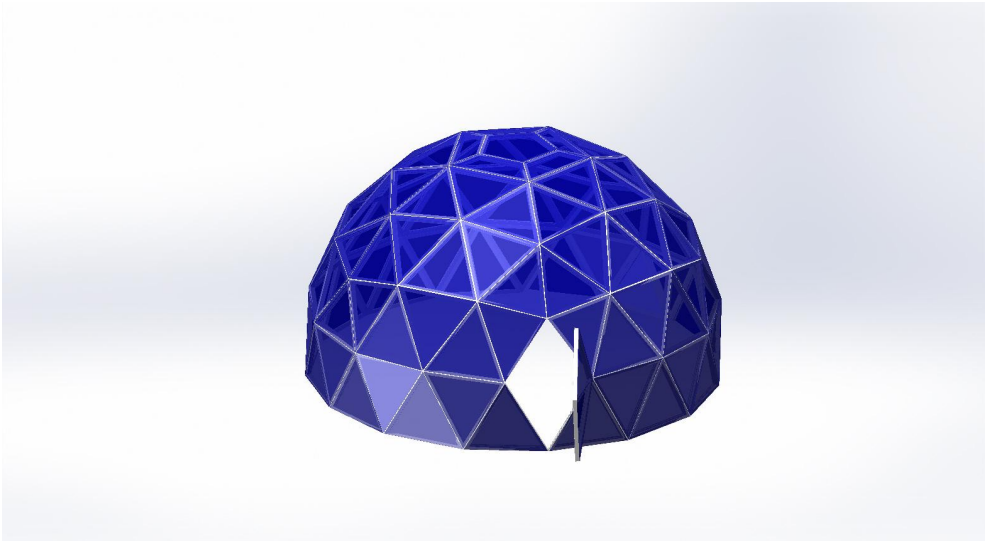

Glass dome outdoor renderings

bubble house The PC Clear Dome Tent/Transparent Bubble House is made of high-quality polycarbonate sheets imported from Bayer. It is colorless and odorless, flame-retardant, high-strength, easy to clean, and the surface is co-extruded with a 50um high-quality UV anti-ultraviolet absorbent layer. The warranty is 20 years. The skeleton, top and bottom are made of high-strength aviation aluminum profiles, which greatly improves the wind resistance and snow load resistance of the star room. It has high safety and strong protection, which increases the safety of passengers living outdoors and dining. Adopting modular installation design, easy installation and disassembly process, low on-site assembly cost..



bubble house inner drawing

Model NO.	Diameter dimension(m)	area covered (m ¹)
bubble house	2-6m	---

- Frame Material:Aviation aluminum alloy
- Wall Material:Clear Polycarbonate
- Use Life:20 years
- Door:1 aluminum alloy
- Wind Load:100km/h Window:2-3 widnows Snow Load: 75kg/m²
- Features: 100% waterproof, flame retardent, anti mildew, anti corrosion,UV protection
- Temperature: Can resist temperature from -40℃ to 70℃
- Accessories: fixed base, crew and so on

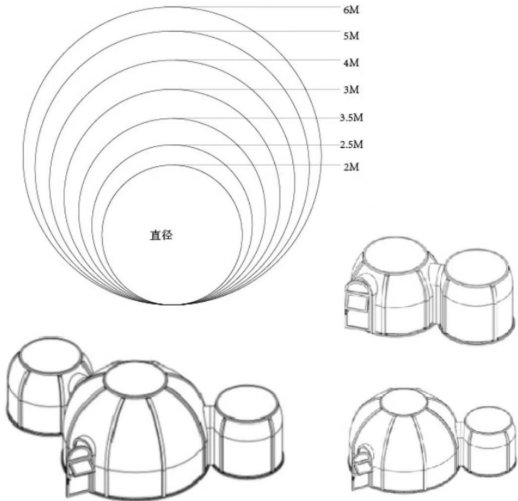

bubble house outdoor renderings

ICupid Tent

The heart-shaped space of two rooms and one hail which interprets the concept of "home" is the original intention of this series; "home"¹ is a kind of destination, a harbor where the heart rests, and it can give people a warm feelrng. Boteen Luxury Tent is committed to making every tent feel cordial, comfortable and casual.



Model NO.	Overall srzeCm)	Indoor size(m)	Overall area (M)	Indoor (m ^l)
Cupid Tent	7 6*7.8*35	4*4.2*13	60.8	16.fi

Rain fly material: standard rain fly/ 750g Stretch film

Inner material: 900D Strong Oxford, waterproof 5000mm

Wind proof: B-1Q level 62-102km/h

Structural material; main pole. 7&mm galvanised steel pole, 1.5mm 响, E thickness,

Connecting pole. 83mm steel pole, 2.0mm wait thickness(strongX black / outdoor special painting treatment /argon anc welding (durable under the sun and rain).

Fabric material: 750G Stretch Film, self-wash funcliGn. waterproof 10000mm. UM protect 50+, fire resrstance (CPAb8^) US standard, mildew proof, Antl-mosquhia Beige



Cupid Tent inner drawing



Cupid Tent dimensions

I Water drop starry sky tent

It can be well integrated into the surrounding natural environment, and its internal structure can bring more spacious accommodation space, and there is a transparent ceiling above the tent. When night falls, open the ceiling to experience the fun of the starry sky.



Model NO.	Whole size(m)	Whole areaCm¹)	cloth
Water drop starry sky tent	4*4*2.85	12.56	Oxford / cotton
	5*5*3.15	19.62	
	6*6*3.50	28.26	

Fabric material: 900D Oxford, PU Coating, waterproof 5000mm, UV protect 50+, fire resistance (CPAI-84) US standard, mildew proot 285g cotton, PU Coating, waterproof 3000mm, mildew proof UV protect Wind proof: 5-6 level, 34-44km/h

Ceiling: Low temperature resistant transparent TPU (-40 degrees Celsius)

Groundsheet: 540g fire-retardant PVC, waterproof 5000mm, mildew proof Moisture proof

Center pole: 38mm*1.5mm galvanized steel pole, side poles: 13mm fiberglass

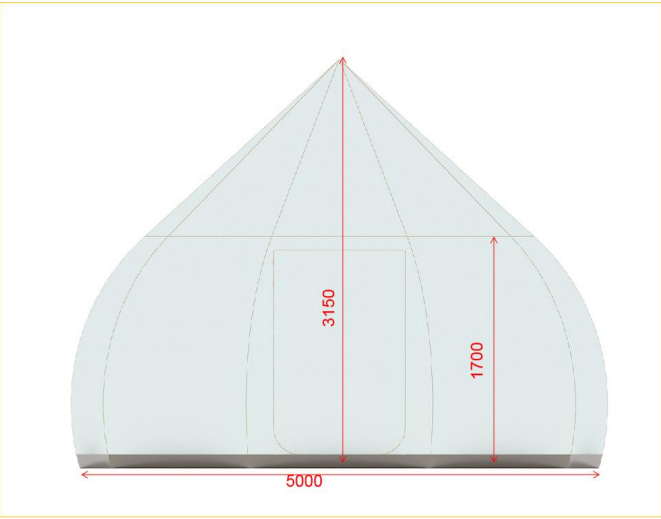

Water drop starry sky tent inner drawing

Water drop starry sky tent dimensions

I BELL - 400 Simple design, unique spire shape let you enjoy the original and natural feeling; affordable price, easy to build St store, easy to carry.

it is deeply loved by customers.



BELL MOOT包 nt inner drawing

Model NO	Whole size(m)	Whole area(m')	cloth
BELL - 400	3*3*2.0	7.00	Oxford / cotton
	4*4*25	12.56	
	5*5*30	19.62	
	6*6*35	2826	
	7*7*35	38.47	

Fabric matehal: 900D Oxford, PU Coating, waterproof SOOOmm. UV protect S0+.
fire resistance

(CPA/• 醇)US standard, mildew proof, 320g cotton, PU Coating, waterproof 3000mm,
mildew proot UV protect

Wind proof 5-6 level, 34 44km/h

Groundsheel 540g fire retardant PVC, waterproof 5000mm, miMi?w proot Moisture
proof

Support poles. 3B*1 Smin giilvrimized steel pole, door pole 19*1 Omm galvanized

Meel pole

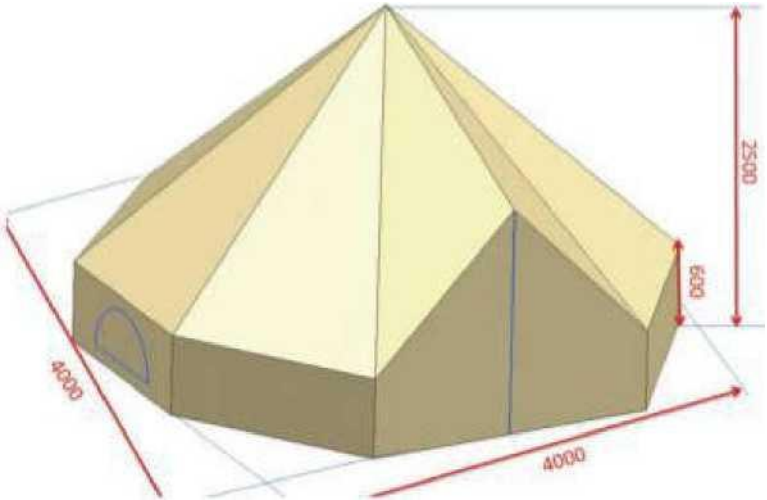

BELL-400 Tent dimensions

I BELL - 460 How can you miss the tent when playing outdoors? The tent is a good "canopy" friend for outdoor play. The designer of this tent designed a large space of 6*4 meters and designed three doors in different directions, so that passengers do not have to worry about entering and exiting, even if there are more friends, the entry and exit will still Convenience and adds a feeling of a home"

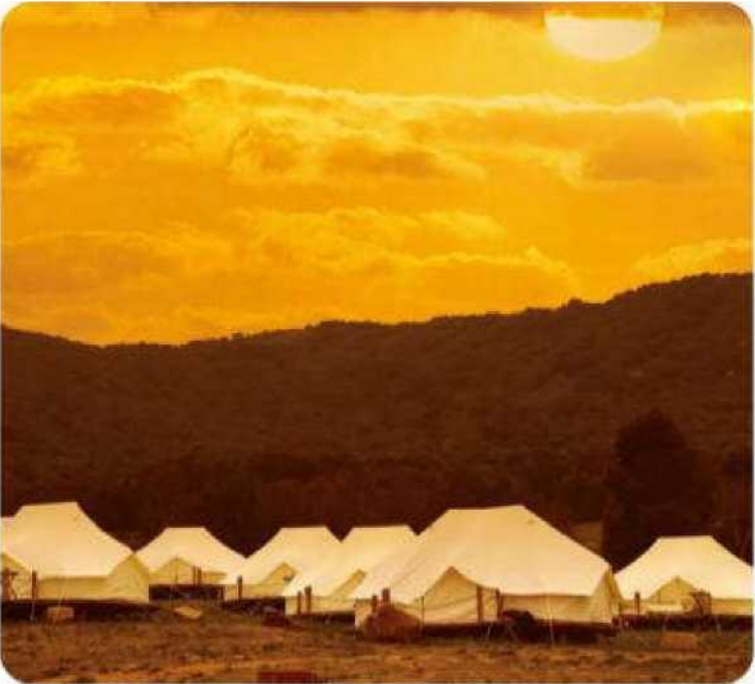

BELL-460 Tent inner drawing

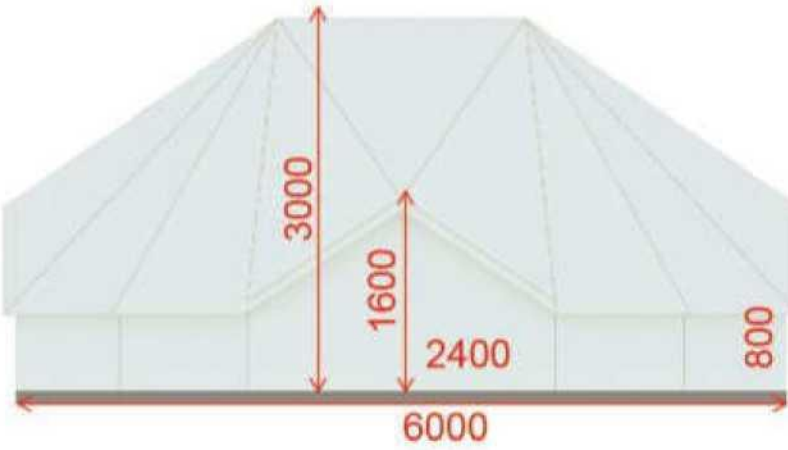

BELL-460 Tent dimensions

Model NO	Whole size(m)	Whole area(m²)	Material
SELL-460	4*6*3		Oxford / cotton

Fabric material: 900D Oxford, PU Coating, waterproof 5000mm.. UV protect 50+, fire resistance

(CPAI-84) US standard, mildew proof, 320g cotton, PU Coating, waterproof 3000mm, mildew proof UV protect

Wind proof: 5-6 level, 34-44km/h

Ground sheet S^Og fine-retardant PVC, waterproof 5000mm, mildew proof. Moisture proof

Support poles 38*15mm galvanized steel pole, door pole: 19* 1.0mm galvanized

Steel pole

I BELL - 500 Retaining the original camping flavor the inner tent is an independent yurt, which is easy to build and store. The canopy is like a root adding a different feeling With a simple home style, it creates a comfortable and comfortable outdoor living



BELL-500 Tent Inner drawing

Model NO.	Overall Srze(m)	Indoor size(rn)	Overall area (nnf)	Indoor (m¹)
BELL- 500	5*7*2 8		35	11

Rain fly rftater^l: standard rain fly/ 1680D strong oxford

Inner material: 900D Strong oxford, waterproof 5000mm

Wind proof . &9 level, 50-88km/h

Structurjil material; ma泊 pole, 46<Tini galvanized steel pole, 1.5mm wall thickness (strong and painless), Connecting pole. SOmm steel polefstr&ng), / outdoor special painting treatment /argon arc welding (durable under the sun end rain).

Fabric materialS80D Strong Oxford, PU Coating』 waierproQf 5000mm, UV protect 50

七 fire resistance

(CPAi 84 } US standard, mildew proof, Anti^rnasquito, Beige



BELL-500 Tent Dimensions

1 BELL-600 The "eaves" design makes the passengers fee) more happy while using it. There is no noisy, no trouble, and bland life here.

Living here is not only a sleep, but also a kind of thinking about "sleep" . Make your heart return to nature.



Model NO.	Overall size(m)	Indoor size(m)	Overall area (hf)
BELL - 600	45*6.5*3	45*45*3	

Fabric material: 900D Oxford, PU Coating, waterproof 5000mm.. UV protect 50+,^ftr^ resistance (CPA1-S4) US standard, mildew proof, 320g cotton, PU Coating, waterproof 3000 (nm, mildew proof UV protect Wind proof 5-6 level, ^4^4k^rn/h

Ground^heat: 540g fire-retardant PVt, waterprcof 5000mm, mildew proot Moisture proof

Support poles: 18*1 Smm galvanised steel pol色 19mm ga^anized *steel*/ pole; 19mm extension pole



BELL-600 Tent inner drawing

BELL-600 Tent dimensions

Indian Spire tent It is very easy to disassemble and assemble. It is equipped with a very comfortable bed and blanket inside-

You can enjoy the romantic starry sky as Song as you lie down, and you will be immersed in the natural beauty for a moment.



Mode! NO.	Whole size(m)	Whole area(m')	cloth
Indian spire tent	3*3*Z5	7.00	Oxford / cotton
	4M*3.O	12.55	
	5*5*35	19.62	
	6*6 M.Q	28.26	

Fabric matk 900D Oxford, PU Coating, waterproof 5000mm, UV protect 50+,fire resistance (CPA^-84) US standard, mildew proof. 320g cotton. PU Cgting」 waterproof 3(K)0rnnn, mikiew proof, UV protect Wind proof: 5-6 level 34'44km/h

Ground she«i: S40g fire-retardant PVC, waterproof 50130mm, mildew proot Moisture proof

Support pales: 38*I.Smmgaivanjzed steel pole



Indian Tent inner drawing



Indian Tent dimensions

Itouareg The exterior is a simple and unique tent shape, and the interior is a comfortable and light luxury star hotel layout.

allowing you to fully enjoy the outdoor luxury experience.



Model IMG	Whole size(m)	Whole area(m²)	cloth
Little Touareg tent	4.4*3*235	13.2	Oxford/cotton
Big Touareg tent	5,0*4*3.00	20	Oxford / cotton

Fabric mat;900D Oxford. PU Coating, waterproof 5000mm, UV protect 50+,fire resistance (CPA^84) US standard, mildew proof. 320g cotton. PU Cgting, waterproof 3(K)0rnnn, mikiew proof, UV protect Wind proof: 5-6 level 34'44km/h

Ground she«i: S40g fire-retardant PVC, waterproof 50130mm, mildew proot Moisture proof

Support pales: 38*I.Smmgaivanjzed steel pole, door pole: 19* 1.0mm galvanized steel pole.



loti a reg inner drawing

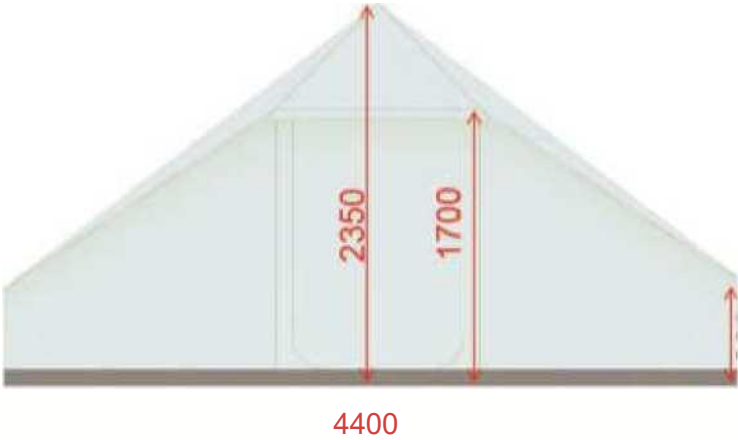

Touareg dimensions

SUPPORT SERVICES

PLATFORM FLOOR HEATING BATHING AIR CONDITIONING Floor, floor heating, bathing, air conditioning

From tent hotel product design, material selection, customized production, to resort tent layout, interior planning, interior design, and all issues affecting the accommodation experience, such as ventilation, heat preservation, privacy, safety, etc., Boteen can give you a full range of solution.

Wooden Floor



MODEL NO.	RESORT TENT WOODEN FLOOR	
WHOLE FRAME	60mm*40mm*2.0T(thickness) galvanized steel poles	
FIST LAYER MATERIAL	Anticorrosive wood strip 10*2.5cm (width*thickness) heightened: 30~70cm	
SECOND LAYER MATERIAL	Moisture-proof compressed wood board 1.5T (thickness)	

air conditioner



MODEL NO.	MIDEA HP2	GREE HP2
SIZE (mm)	Internal machine 405*1775*380 Outside machine 982*712*398	Internal machine 400*1811*468 Outside machine 899*596*378
SUITABLE FOR AREA (m²)	23~34	20~30
AREA (m²)	0.164	0.187
AIR CONDITIONING PERFORMANCE	Fast cooling and heating, a lot of wind, high-density silver ion filter.The evaporator is thermally dry and clean, and the silent gear is as low as 23 decibels.	The evaporator is self-cleaning, independent of moisture, and left and right sweeping wind Wide voltage design, reminder of lack of refrigerant.

Korean non-radiation electric floor heating (DAEYOO)	Environmentally friendly carbon fiber electric floor heating(SNCNKJ)	MODEL NO.
Carbon fiber board, non-magnetic boundary board, PET upgrade board Surface compound 9 filament PET anti-static coating	Cement layer, PE film, extruded board, reflective film Fiber mesh, heating wire, wood floor/floor tiles	FRAME
180W	230W/group	POWER
Automatically power off above 65 degrees Celsius	inner260°C out 125°C	TEMPERATURE RESISTANCE
Anti-static, safe and fast heating, durable, non-flammable	Environmentally friendly, flame-retardant, instant heat, silent workEnergy saving, money saving, incombustible	FEATURES



electric floor heating

TOILET	TOILET	MODEL NO.
PMMA,Aluminum alloy, tempered glass, PMMA pressure grinding forming	SMC Molded body	MATERIAL
1.1×1.4×2.1	1.4×1.8×2.2	SIZE (M)
1.6	2.52	WHOLE SIZE (m²)
Basin, toilet, silver float mirror, shower Towel bar, ventilating fan, ceiling light, integrated shelf	Square basin P-shaped basin, basin faucet, vanity mirror, towel rack, one-piece toilet,Shower faucet, towel rack,straight shower curtain and shower curtain rod, LED ceiling light, ventilation fan	inner Accessories



shower system

AOMETER	MODEL NO.
154L*71W*106H	SIZE
main oven : 45*98cm sub-oven 35*47cm	OVEN MESH AREA
Thickened cold rolled steel plate, enamel grilled wire mesh	MATERIAL
Fashion braising, insulation net, enamel main/sub grilling net, carbon net adjustment, parent-child stove	INNER ACCESSORIES



oven

LUXURY HOTEL TENTS OF VARIOUS STYLES

Luxury hotel tents of various styles



CUSTOM DESIGNED HOTEL TENTS OF VARIOUS STYLES

Custom designed hotel tents of various styles

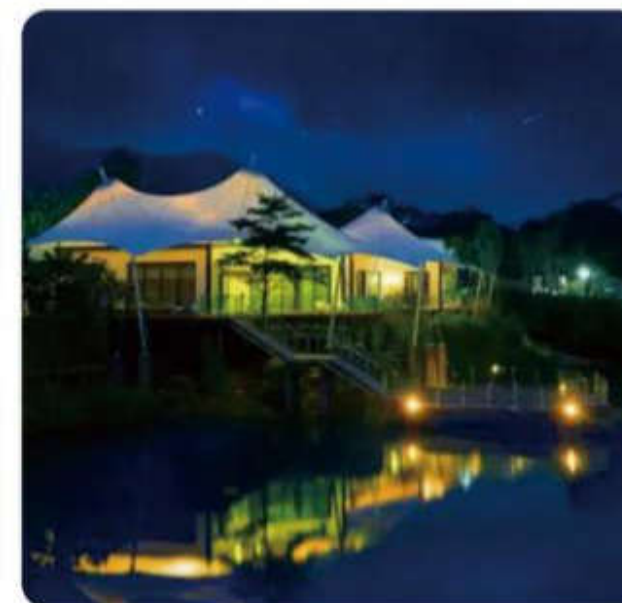
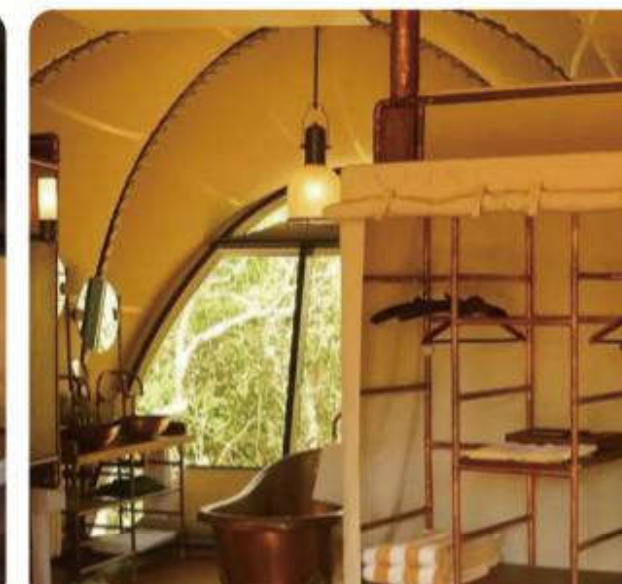

SUPPORT SERVICES INTERIOR DECORATION

Classical style

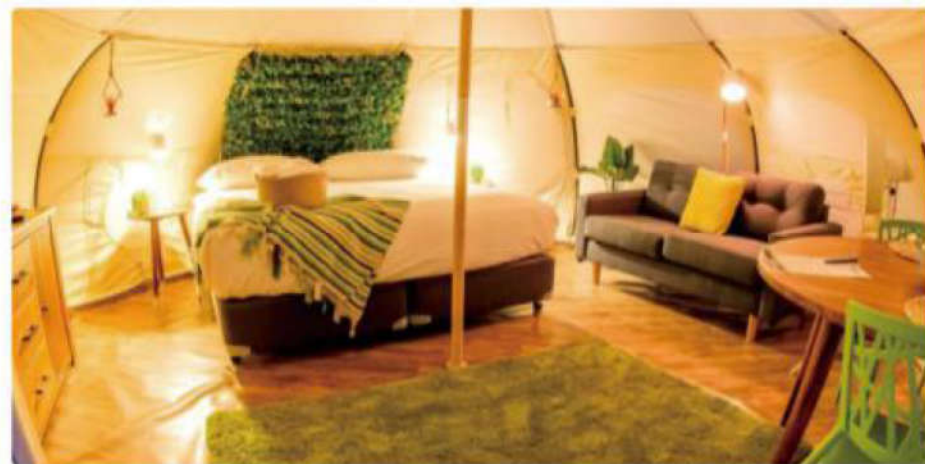

Simple style



Japanese style

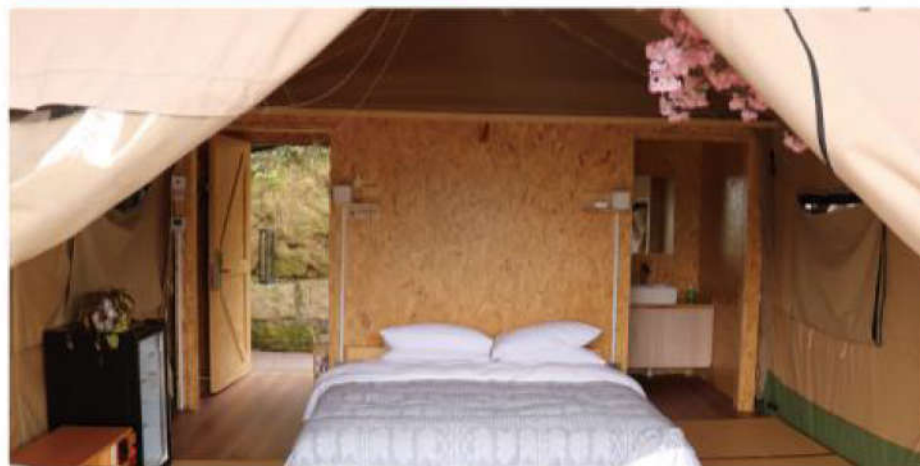

Bohemian style



SUPPORT SERVICES support services

From tent hotel product design, material selection, custom production, to tent hotel layout, interior planning, interior design, and all issues affecting the accommodation experience, such as ventilation, heat preservation, privacy, safety, etc.,



Camp rules

Boteen has a wealth of experience in the construction of tent hotels and characteristic camps. Before formulating the plan, it can survey the topography of the customer on the spot, and design the most suitable campsite layout plan.



Sun protection

The high-quality PVC tarpaulin used in tent hotel has a certain anti ultraviolet ability, which can well sunshade and sunscreen. In addition, curtains and cloth curtains can be installed in the tent, so that tourists can choose sunshade mode by themselves.



ventilation system

The double-layer tarp design of the luxury tent hotel allows an independent ventilation system to be formed inside the tent, which can ventilate scientifically. At the same time, customers can design the number and location of windows or install other ventilation equipment according to their needs.



Insulation

The design of the tent hotel is ingenious, only the doors and windows are in direct contact with the outside air, so that the internal temperature change always lags behind the outside temperature change. The temperature inside the tent is stable, warm in winter and cool in summer. In addition, air conditioning can be installed.



Hydropower Sewage

Boteen's professional team will design reasonable water, electricity and sewage design drawings based on the construction site for customers' reference. Customers can also choose all-inclusive services to build a tent hotel in one step.



ensure safety

Boteen luxury tent hotel adopts a combined steel pipe structure frame, which can be used safely and stably in different sites. Outdoors can withstand 7-9 level strong winds and carry rain and snow. It is suitable for the environment -20-40°, ensuring safety.



Private issues

The walls of the Boteen Tent Hotel are made of beige Oxford fabric, which is very safe. The window curtains can be pulled up during the rest time to effectively protect personal privacy.



Service life

Boteen Tent Hotel has a long life span of 5-10 years under normal use. In addition, we also provide a one-year warranty period.



Production time

The normal cycle of a conventional tent product is about 25-30 days, but if it is an unconventional standard tent product or a program customization is required, a certain design cycle is required. The specific time is based on the final contract.

Our Hotel tents cases TENT HOTEL CASE

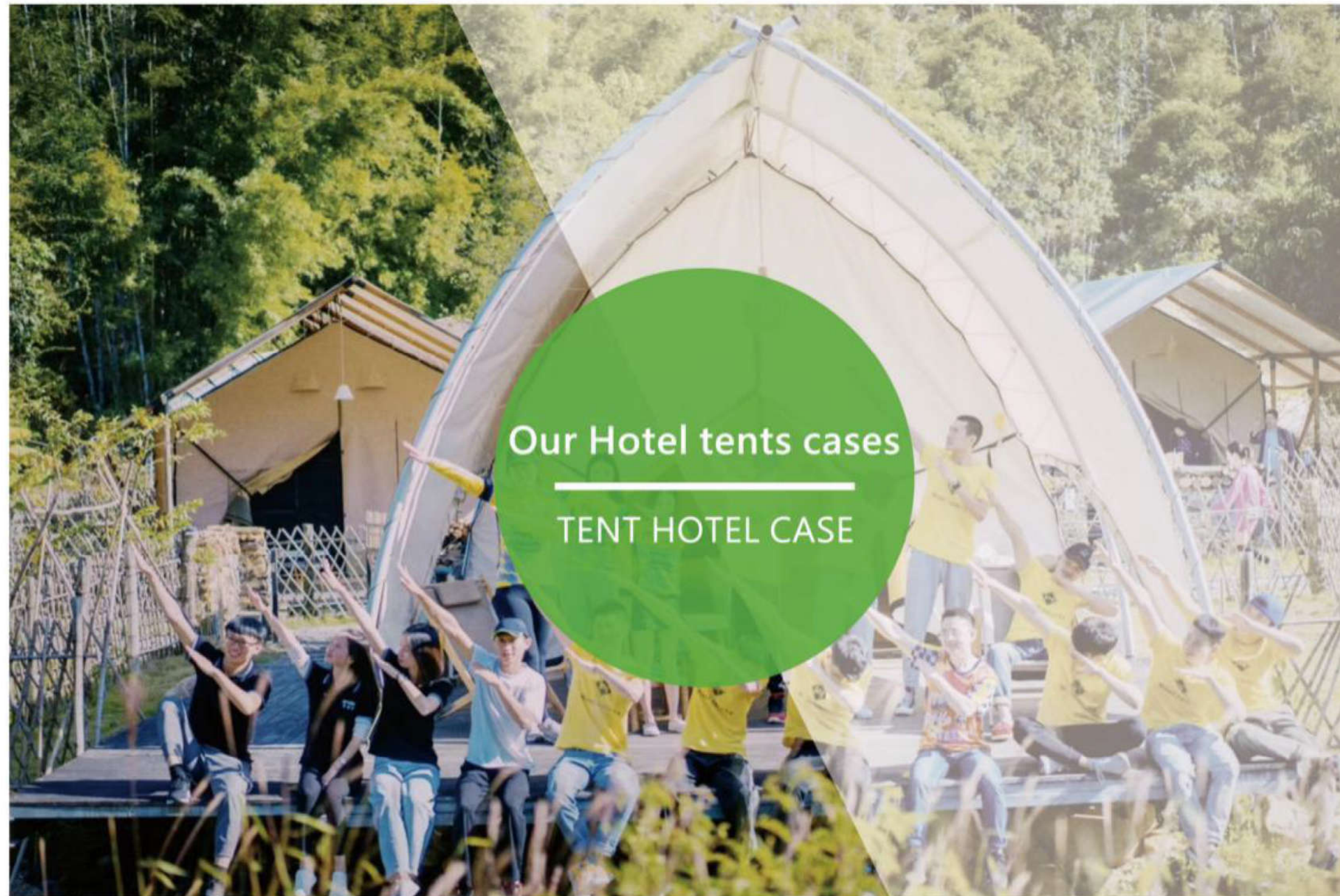



Qingyuan - Pu camp site

The tent made of wood and canvas is located at the foot of the mountain and blends with nature.

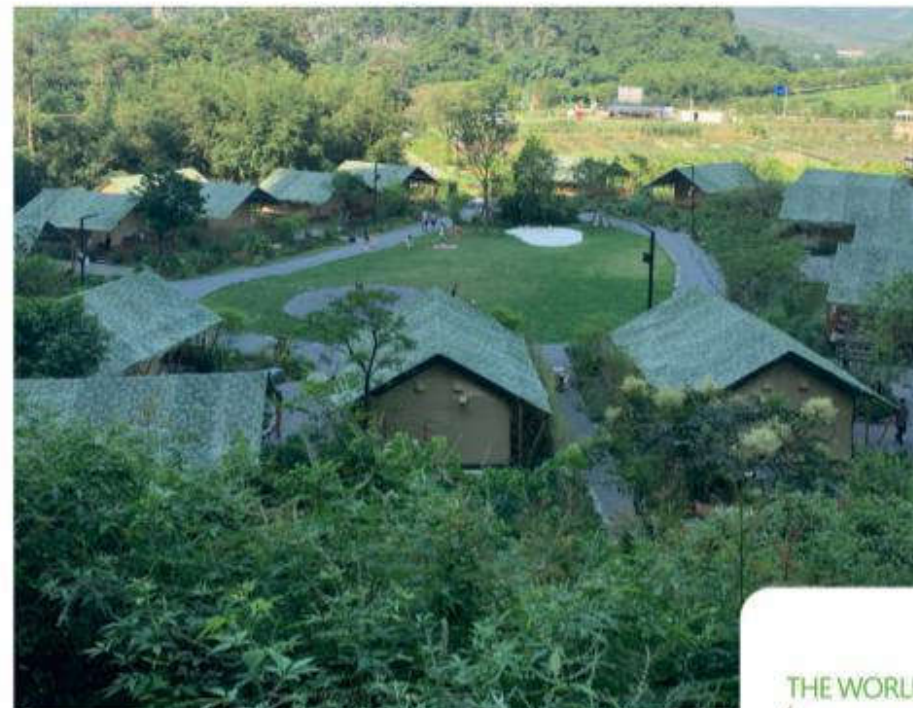

THE WORLD IS SO BIG

I WANT TO VISIT

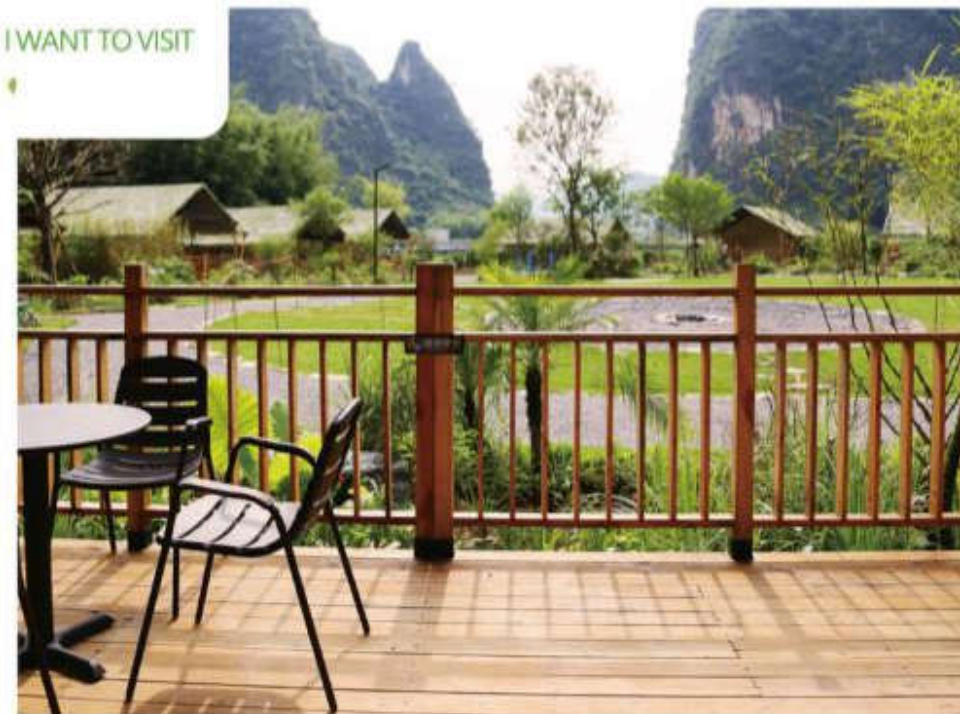

WEIHAI - XIXIAKOU

Share a good time
Witness the greatness of nature

There are sunshine, sea, beaches, islands, and fresh air. Here you can see the most beautiful coast of mainland China, have close contact with the gulls and herons, play with the blue water, and experience the luxurious accommodation of the outdoor masterpiece "hotel tent". Experience is a great choice for families to enjoy a summer beach holiday.





VALLEY OF THE WIND CAMP SITE

AWAY FROM THE HUSTLE AND BUSTLE OF CITIES, GO TO THE VALLEY OF THE WIND TO EXPERIENCE THE LONGING LIFE. THE CAMP SITE OF THE VALLEY OF THE WIND IS LOCATED BESIDE WANLV LAKE IN PINGLING TOWN, LONGMEN, HUIZHOU CITY. THE WHOLE CAMP SITE IS DESIGNED AROUND WANLV LAKE. ONLY TWO HOURS' DRIVE FROM GUANGZHOU, SHENZHEN, DONGGUAN CITY.



JIURU MOUNTAIN CAMP SITE

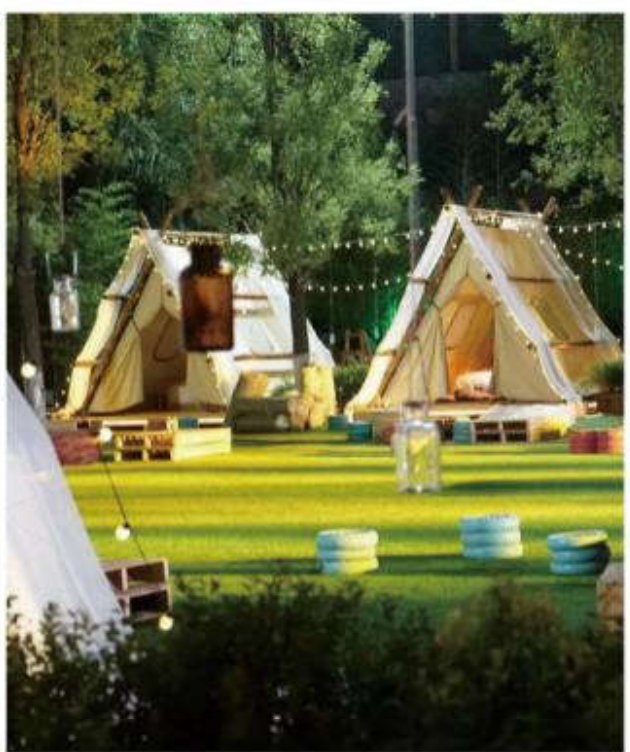

A wonderful life like a fairy-land starts from walking into nature. The hotel is meticulously prepared and decorated, and every place releases a romantic atmosphere... If you want a high-quality life experience, come on a walk-and-go trip.



XINJIANG NO MAN'S LAND CAMP

In the hinterland of the Taklimakan Desert, the second largest desert in the world, there is an oasis called "a paradise" by archaeological explorers. Little is known because of its isolation. This oasis is full of mystery Daliabuyi.

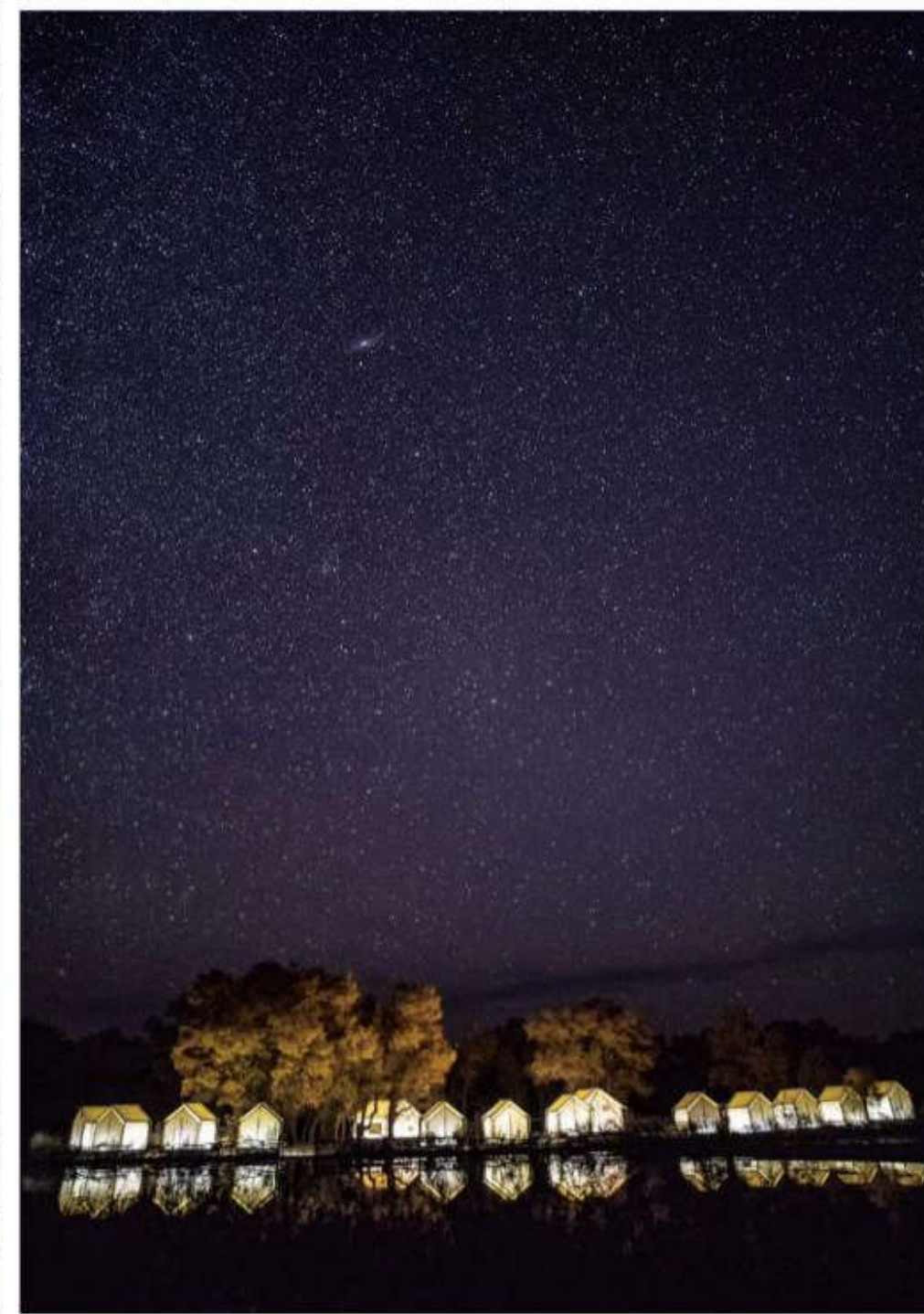
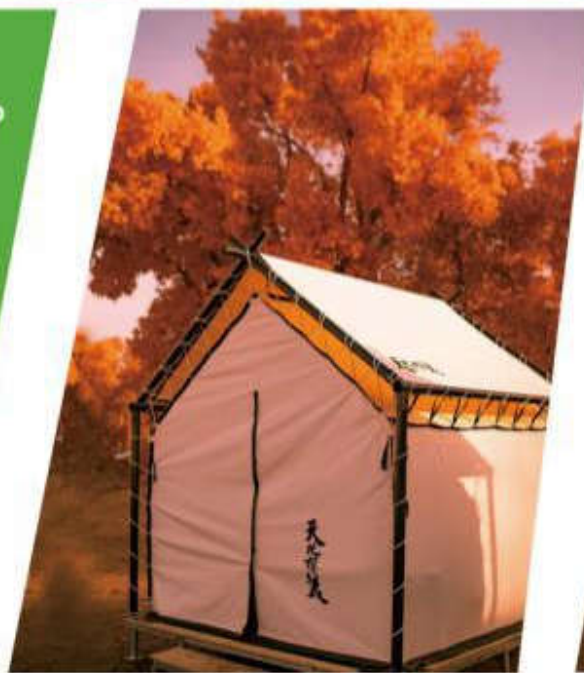



Daejeon, South Korea



Gyeongje-do, South Korea



Dongying, Shandong



Quzhou, Zhejiang



Xishuangbanna Campsite



Xining City East District



White Crane Villa in Wenzhou



Cocoa Garden in Thailand



Hualien in Taiwan



Qinghai Lake



Poyang Lake



Laos



Morning Sun Hotel Handan, Hebei



Guizhou Hot Air Balloon Camp



Guilin, Guangxi



Millennium Hotel Hangzhou



Hengdian Campsite



Muyun, Gannan, Gansu



Guangxi Guilin



Chongqing Gujian Mountain



Shiyan



Changshu Camping Camp



Gansu Shangshui Tent Camp



Changde Shuimu Jiayuan



Sanya Monkey Island Bay Tent Camp



Lijiang Dongba Valley Camp



Lin'an Zhexi Grand Canyon



Hunan Changde Campsite



Ganzi Prefecture, Sichuan



Phoenix Dam, Guizhou



Xiahe County, Gansu Province



Jilin Tonghua Camp



Changsha, Hunan



Mianyang, Sichuan



South Korea



Zhangjiakou Tianmo Scenic Area



HOW TO HELP YOU PLAN AND DESIGN?

1

Boteen Outdoor will have professional salesmen to understand the details of your project in all aspects. Require professional engineering personnel to survey and map on site and make site planning.

1

In the Boteen consulting tent, more than 99% of the clients will be invited to the Boteen campView and experience different products, and bind their selected products for camp planning design.

2

Boteen designers will create your own space solution, using 3D models to transfer you. The idea or concept is shown in advance for your reference.

3

Boteen will launch new tents every quarter. Welcome to Boteen to experience it. Outdoors are like home Life, Boteen carves for you.

SPECIAL SERVICE

SUPPORT SERVICES SUCCESSFUL PROJECT CASES

Boteen Luxury provides different characteristic services according to the different needs of customers.



PLANNING

Free to provide planning and design



SERVE

Free customized services



DILLA COM

Free resource sharing



RESOURCE

Free platform promotion



SERVICE

Provide operation advice free of charge

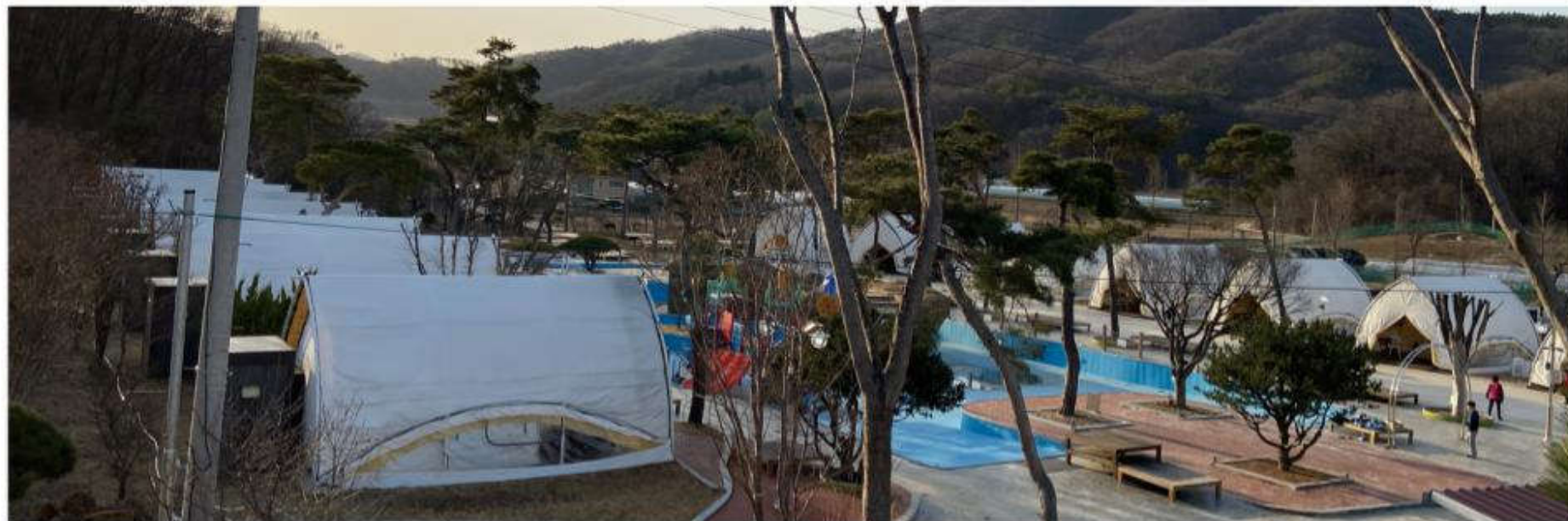

01

We can provide luxury tent hotels with an area of 10-108 square meters. The space is flexible and changeable. If you need other sizes or special needs, we provide personalized customization services.



Product customization

02

Boteen can equip each tent hotel with luxurious decoration and complete sets of furniture and equipment, and can also provide professional interior design suggestions, allowing customers to choose the appropriate supporting facilities.



Customized interior

03

We have a self-built professional installation team, ready to prepare 24 hours a day, and strictly inspect the products before shipment. Installation tests will also be conducted to ensure product quality in all aspects.



Installation team

YOU DESERVE TO HAVE ONE-STOP CUSTOMIZED SERVICE!



Resource exchange

RESOURCE INTERCHANGE



HOTEL TENTS AND CAMPS

PROMOTION ON QQ, WEIBO,

WECHAT, HEADLINES, ETC.,

AND BRAND PROMOTION

OF SOFT ARTICLES AND VIDEOS ON INTERNET SITES.



CAMP HOTEL TENT EXHIBITION

CAMP OPERATION PLAN

INTRODUCTION TO THE LAYOUT OF THE TENT



Are you worried about the construction of hotel tent camps?

Are you worried about the cost recovery after investment?

Are you worried about operation after construction?

Worried about no publicity method?

How to make a hotel tent camp content?

Consult Boteen, we will give you the answer you want.

Tourle Outdoor will help you solve all your problems.

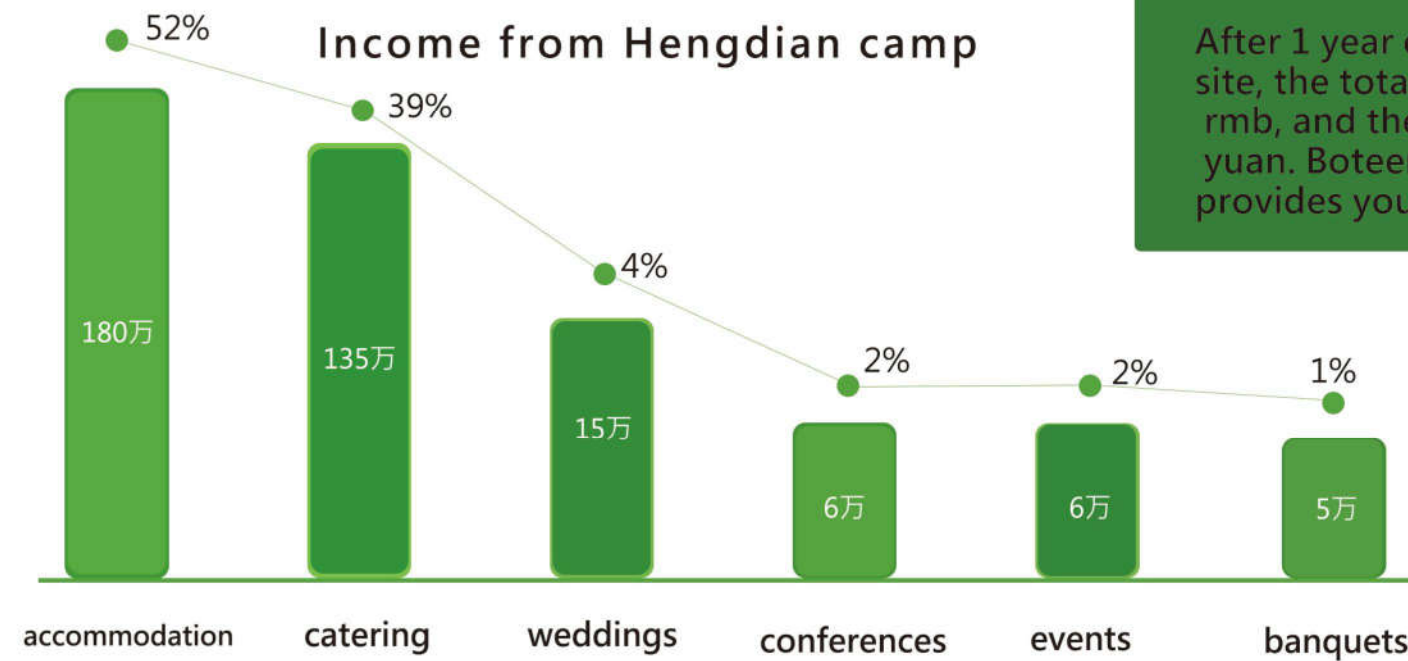
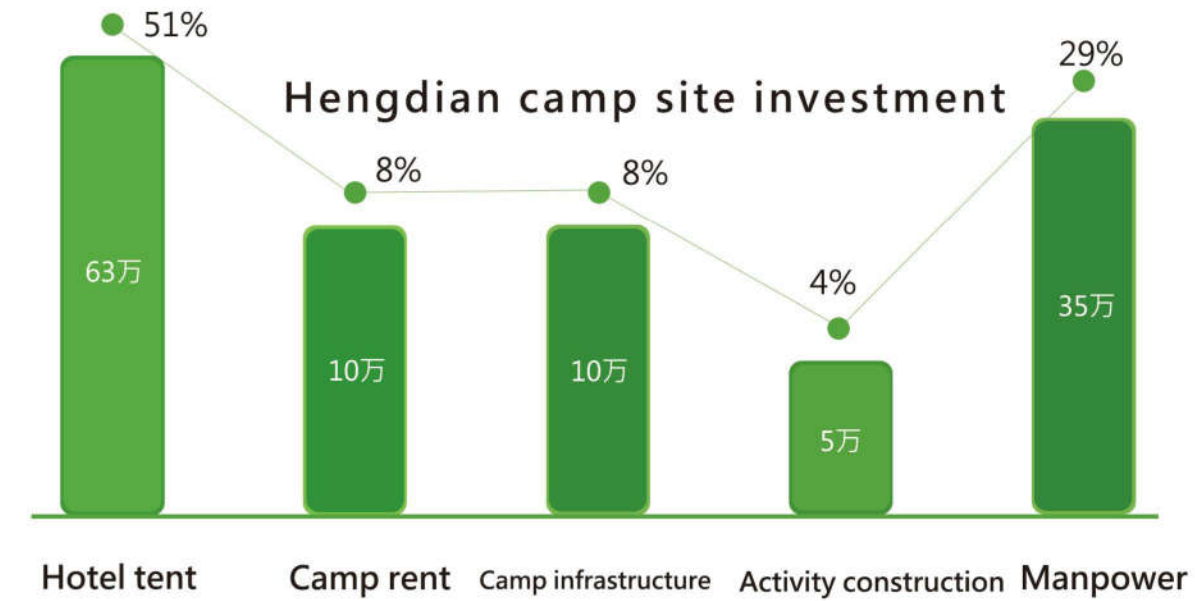

After 1 year of operating Hengdian camp site, the total income is 3.47 million yuan rmb, and the profit has been 2.24 million yuan. Boteen's refined operation plan provides you with



Hengdian camp project operation marketing case

SERVICE PROCEDURE

Warm and romantic

Make Outdoor life just like home life, Boteen make for youExplore the infinite scenery and appreciate the special hotel

Multiple patented technologies

Obtained a number of invention patents and practical patents, and owns independent intellectual property rights; continuous experiments to verify and improve products.

Integrated services

R&D, design, sales, and construction are integrated services to ensure production quality throughout the entire process; efficient construction team on-site assembly, short cycle, low cost, personalized tent design.

Lifetime technical support service

The design, materials, tent structure, and construction methods are comprehensively improved; the performance of fire prevention, flame retardancy, mosquito prevention, and light weight is excellent; the expert team guarantees lifetime technical support and services.

professional team

The expert team personally inspected the design; designed the tent camp site solution according to the actual situation.

Understand project site planning

- 1 Site planning shall be carried out by engineering personnel with more than five years of experience in field surveying and planning.

Determine the plan and with 3D display

- 2 The designer will create an exclusive space solution for you, and use the 3D model to show your ideas or concepts in advance.

Quotation and sign contract

- 3 Once the plan is confirmed, after detailed accounting, we will provide you with a satisfactory quotation

Production Plan

- 4 Reasonably plan the production schedule, high-precision CNC equipment for efficient production, high-precision technology brings higher-end tent quality

Installation test

- 5 With details for perfection, the professional team will conduct strict quality inspections before shipment, and finally arrange tests to ensure excellent quality.

Global delivery Global direct supply

- 6 Professional logistics team, ready for delivery 24 hours a day, can quickly transport goods to all parts of the country to ensure timely delivery.

On-site construction

- 7 The installation team arrives at the site to build and install, and follow up and maintain the whole process during the event to ensure the smooth completion of the installation.

Installation and acceptance

- 8 After the installation is completed, professional and technical personnel will carry out technical acceptance of the project to ensure the safety and stability of the project.

After-sales support and service

- 9 Provide after-sales maintenance, accessories replacement, inventory replenishment and other services. If you encounter any problems during after-sales use, we will provide you with technical support.



Certificate



Boteen unique patent



Applicant / patentee: Yiwu Boteen Tourism Development Co., Ltd.